

# ATTENUATORS

## TNC up to 6 GHz, 100 Watts

### SPECIFICATIONS:

Models: XT100W-XX, XT100W-XXF, XT100W-XXM

**RoHS**  
Compliant

**AEROFLEX**  
A passion for performance.

#### Electrical:

Frequency Range	DC - 6.0 GHz
Standard Freq. Values	2.5 & 6 GHz
Standard dB Values	3, 6, 10, 20, 30 & 40 dB
Attenuation Accuracy	DC - 1.5 GHz    1.5 - 2.5 GHz    2.5 - 6 GHz
3 & 6 dB	±0.50 dB    ±0.50 dB    ±0.75 dB
10 dB	±0.75 dB    ±0.75 dB    ±2.50 dB
20 & 30 dB	±0.75 dB    ±0.75 dB    ±1.50 dB
40 dB	±1.50 dB    ±1.50 dB    ±2.50 dB
VSWR (Max.)	1.25:1    1.35:1    1.45:1
Input Power	100 Watts Avg. Derated Linearly to 20 Watts @ +125°C
Reverse Power	20 Watts Max.
Peak Power	1 kW Max. (5uSec Pulse, .05% Duty Cycle)
Impedance	50 Ohms
Operating Temp Range	-55°C to +125°C

#### Mechanical:

TNC Connectors	Passivated Stainless Steel Mates with MIL-STD-348
Conductors	Gold Plated Beryllium Copper
Housing	Anodized Aluminum

Custom Mtg. hole Config.  
may be Added to this  
Surface

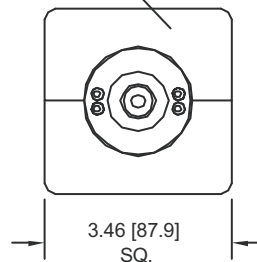

**END VIEW  
TYPICAL**

Units must be Mounted in such a way as to  
Allow for Free Air Flow Around fins to Assure  
Performance

Note: Units are Unidirectional, Therefore Input Connector MUST be specified & will be Indicated on Unit

Model Number: **XT100W-XX**  
Male/Female Connectors  
Length: 6.53 ±.05 [165.9 ±1.3]  
Pictured

Model Number: **XT100W-XXF**  
Female/Female Connectors  
Length: 6.62 ±.05 [168.1 ±1.3]

Model Number: **XT100W-XXM**  
Male/Male Connectors  
Length: 6.43 ±.05 [163.3 ±1.3]

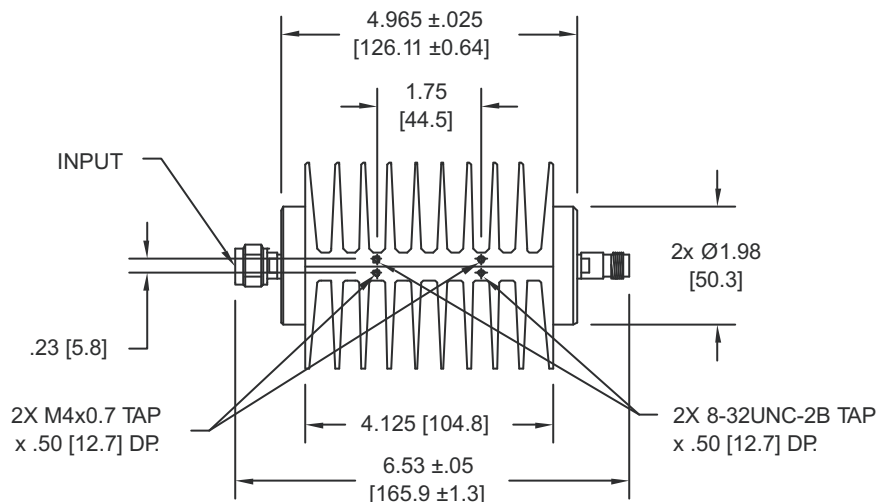

### HOW TO ORDER:

Model Number: **XT100W-XXY**

Freq. Range  
2 = DC - 2.5 GHz  
6 = DC - 6 GHz

dB Value

Connector Configuration  
= Male/Female  
(Male Input)  
F = Fem/Fem  
M = Male/Male  
FM = Female/Male  
(Female Input)

### Ordering Examples:

Model Number: **2T100W-01**  
DC - 2.5 GHz, 1 dB; TNC - Male/Fem

Model Number: **2T100W-03F**  
DC - 2.5 GHz, 3 dB; TNC - Fem/Fem

Model Number: **6T100W-20FM**  
DC - 6 GHz, 20 dB; TNC - Female/Male

Note: Dimensions in Brackets are Expressed in Millimeters and are for Reference Only.  
Design, specifications are subject to change without notice. Contact factory for technical  
specifications before purchasing or use.

XT100W-ATT: REV N

**AEROFLEX**  
INMET

Aeroflex / Inmet, Inc. • 300 Dino Drive, Ann Arbor, MI 48103 • U.S.A.  
888-244-6638 or 734-426-5553 • FAX: 734-426-5557  
www.aeroflex-inmet.com • inmet-sales@eroflex.com