

ATTENUATORS

TNC, up to 18 GHz, 25 Watts

SPECIFICATIONS:

Models: XXT25W-XX, XXT25W-XXF & XXT25W-XXM

RoHS
Compliant

AEROFLEX
A passion for performance.

Electrical:

Frequency Range	DC - 18.0 GHz
Standard Freq. Values	6, & 18 GHz
Standard dB Values*	3, 6, 10, 20, 30 & 40 dB
Attenuation Accuracy	DC - 6 GHz 6 - 12.4 GHz 12.4 - 18 GHz
3 - 6 dB	±0.30 dB ±0.50 dB ±0.75 dB
7 - 20 dB	±0.50 dB ±0.75 dB ±1.00 dB
21 - 30 dB	±0.75 dB ±1.00 dB ±1.25 dB
31 - 40 dB	±1.00 dB ±1.25 dB ±1.50 dB

VSWR

DC - 6 GHz	1.20:1 Max.
6 - 12.4 GHz	1.30:1 Max.
12.4 - 18 GHz	1.40:1 Max.

Input Power _____ 25 Watts Avg. @ 25°C
Derated Linearly to 5 Watts @ +125°C

Peak Power _____ 500 Watts Max.
(5uSec Pulse, .05% Duty Cycle)

Impedance _____ 50 Ohms

Operating Temp Range _____ -65°C to +125°C

Mechanical:

TNC Connectors** _____ Passivated Stainless Steel
Mates with MIL-STD-348

Conductors _____ Gold Plated Beryllium Copper

Housing _____ Anodized Aluminum

**TNC Connectors are 18 GHz Mode-Free

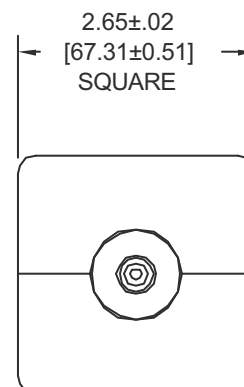

END VIEW
TYPICAL

Units must be Mounted in such a way as to
Allow for Free Air Flow Around fins to Insure
Performance

Model Number: **XXT25W-XX**

Male/Female Connectors
Pictured

Model Number: **XXT25W-XXF**

Female/Female Connectors
Length: 4.75 ±.05 [120.7 ±1.3]

Model Number: **XXT25W-XXM**

Male/Male Connectors
Length: 4.56 ±.05 [115.82 ±1.3]

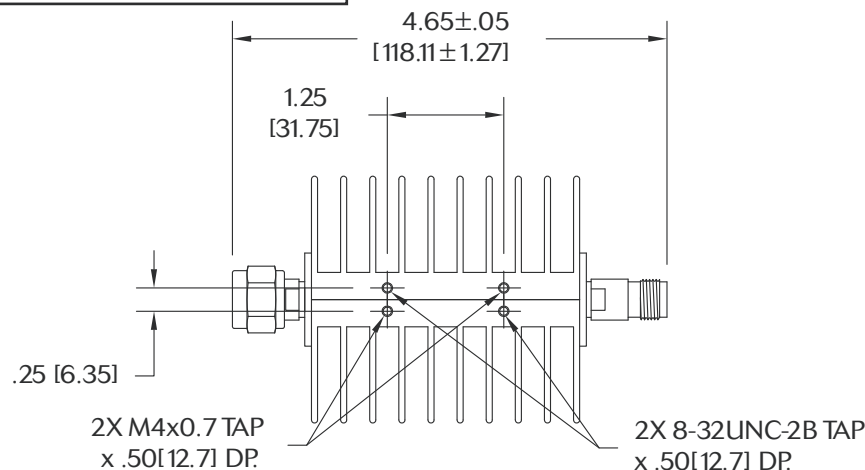

HOW TO ORDER:

Model Number: **XXT25W-XXY**

Freq. Range
6 = DC - 6 GHz
18 = DC - 18 GHz

Connector Configuration
= Male/Female
F = Fem/Fem
M = Male/Male

dB Value

Ordering Examples:

Model Number: **18T25W-20**
DC - 18 GHz; 20 dB; TNC - Male/Fem

Model Number: **6T25W-02F**
DC - 6 GHz; 2 dB; TNC - Fem/Fem

Note: Dimensions in Brackets are Expressed in Millimeters and are for Reference Only.

*Other dB units are also available. Units that operate over a more specific frequency band and/or offer very low return loss (VSWR) are also available.

XXT25W-ATT: REV M (M)

AEROFLEX
INMET

Aeroflex / Inmet, Inc. • 300 Dino Drive, Ann Arbor, MI 48103 • U.S.A.
888-244-6638 or 734-426-5553 • FAX: 734-426-5557
www.aeroflex-inmet.com • inmet-sales@aeroflex.com