

# ADAPTERS, BETWEEN-SERIES

SMA / GPO™ or SMP, DC - 18 GHz

## SPECIFICATIONS:

Models: 5190xx, 5191xx, 5192x, 5193x

**RoHS**  
Compliant

**AEROFLEX**  
A passion for performance.

### Electrical:

Frequency Range \_\_\_\_\_ DC - 18.0 GHz  
VSWR \_\_\_\_\_ 1.20:1 Max.  
Impedance \_\_\_\_\_ 50 Ohms  
Operating Temp Range \_\_\_\_\_ -65°C to +125°C

### Mechanical:

SMA Connectors \_\_\_\_\_ Passivated Stainless Steel  
Mates with MIL-STD-348  
GPO™ /SMP Connectors \_\_\_\_\_ Gold Plated Beryllium Copper  
(GPO Connectors Mate with SMP Connectors IAW MIL-STD-348)  
Conductors \_\_\_\_\_ Gold Plated Beryllium Copper

GPO is a trademark of Corning Gilbert Inc.

Model Number: **5190XX**  
GPO™/SMP Male to SMA Male

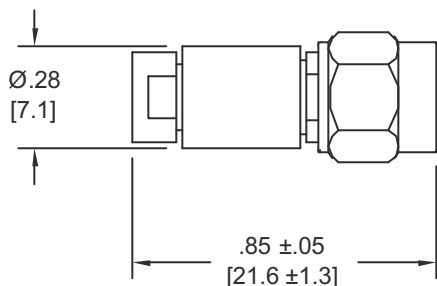

Model Number: **5191XX**  
GPO™/SMP Male to SMA Female

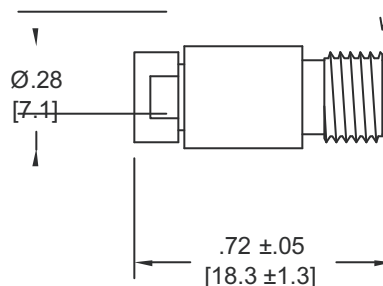

Model Number: **5192X**  
GPO™/SMP Female to SMA Male

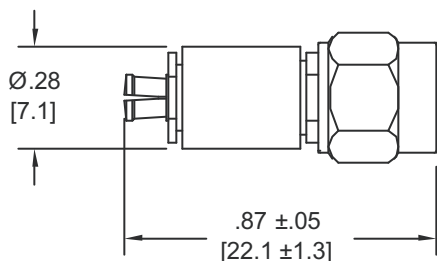

Model Number: **5193X**  
GPO™/SMP Female to SMA Female

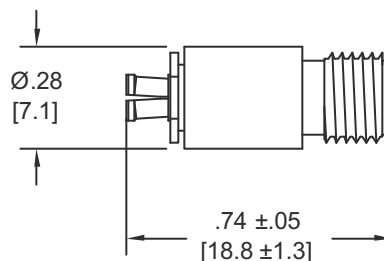

## HOW TO ORDER:

Model Number: **519XYZ**

Base Number \_\_\_\_\_  
As Shown Above

Connector Type \_\_\_\_\_  
G = GPO™ Connectors  
P = SMP Connectors

Connector Style \_\_\_\_\_  
= Full Detent Male Interface  
Force to Engage: 15.0 Lbs. Max.  
L = Limited Detent Male Interface  
Force to Engage: 5.0 Lbs. Max.

### Ordering Examples:

Model Number: **5190G**  
GPO™ Male/SMA Male  
GPO™ Male has Full Detent Interface

Model Number: **5191PL**  
SMP Male/SMA Female  
SMP Male has Limited Detent Interface

Model Number: **5193P**  
SMP Female/SMA Female

Note: Dimensions in Brackets are Expressed in Millimeters and are for Reference Only.

5190: REV D

**AEROFLEX**  
INMET

Aeroflex / Inmet, Inc. • 300 Dino Drive, Ann Arbor, MI 48103 • U.S.A.  
888-244-6638 or 734-426-5553 • FAX: 734-426-5557  
www.aeroflex-inmet.com • inmet-sales@eroflex.com