

Adapters, Between Series

Type N / SMA, DC- 12.4 GHz, Bulkhead Mount

SPECIFICATIONS:

Models: 5293, 5294

RoHS
Compliant

AEROFLEX
A passion for performance.

Electrical:

Frequency Range _____ DC - 12.4 GHz
VSWR _____ 1.20:1 Max.
Impedance _____ 50 Ohms
Operating Temp Range _____ -45°C to +120°C

Mechanical:

Connectors _____ Passivated Stainless Steel
(Mates with MIL-STD-348)
Conductors _____ Gold Plated Beryllium Copper

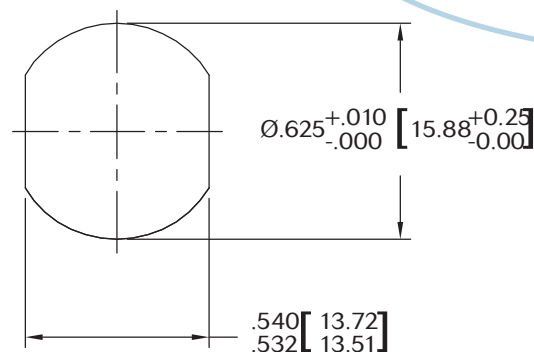

Recommended Panel
Configuration

Model Number: **5293**
Type N Female / SMA Female
No O-Ring Included

Model Number: **5294**
Type N Female / SMA Female
*Includes O-Ring

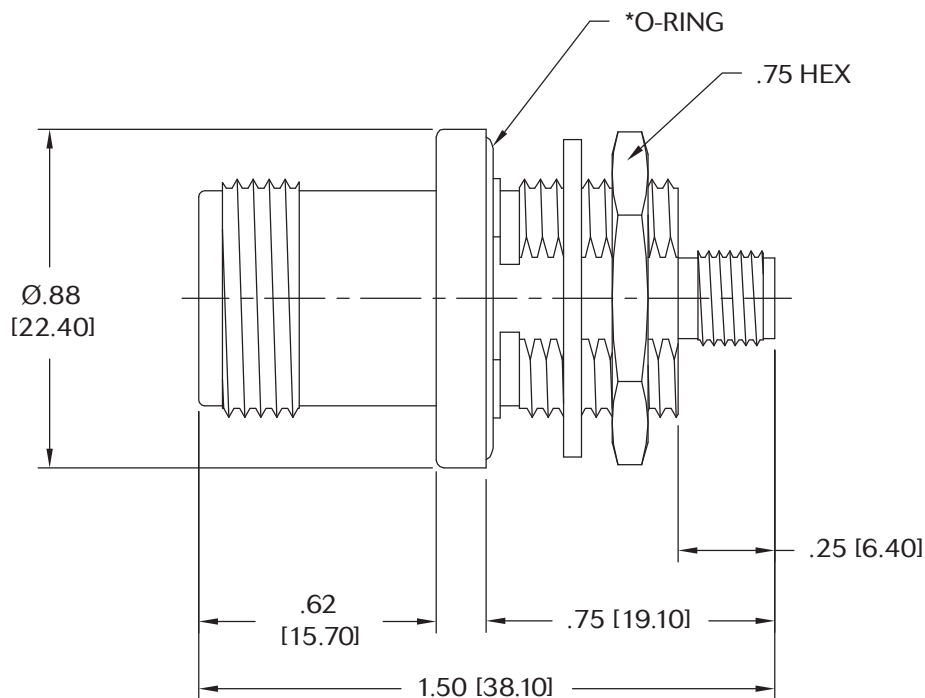

Note: Dimensions in Brackets are Expressed in Millimeters and are for Reference Only.
Design specifications are subject to change without notice.
Contact factory for technical specifications before purchasing or use.

5293: REV B

AEROFLEX
INMET

Aeroflex / Inmet, Inc. • 300 Dino Drive, Ann Arbor, MI 48103 • U.S.A.
888-244-6638 or 734-426-5553 • FAX: 734-426-5557
www.aeroflex.com/inmet • inmet@aeroflex.com