

ADAPTERS, BETWEEN SERIES

TYPE N / SMA, up to 18 GHz, Flange Mount

SPECIFICATIONS:

Model: 5306, 5307, 5308, 5309

RoHS
Compliant

AEROFLEX
A passion for performance.

Electrical:

Frequency Range _____ DC - 18 GHz
Standard Freq. Values _____ 6* & 18 GHz
VSWR _____
DC - 4 GHz _____ 1.04:1 Max.
4 - 8 GHz _____ 1.07:1 Max.
8 - 18 GHz _____ 1.12:1 Max.
Impedance _____ 50 Ohms
Operating Temp Range _____ -65°C to +125°C

Mechanical:

Connectors _____ Passivated Stainless Steel
Mates with MIL-STD-348 _____
Conductors _____ Gold Plated Beryllium Copper

*For DC - 6 GHz Units add -067 to the Model Number

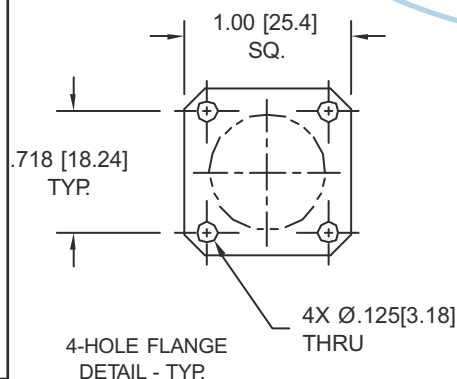

Model Number: **5306**
Type N Male / SMA Male
Length: 1.52 ±.06 [38.61 ±1.52]
As Pictured

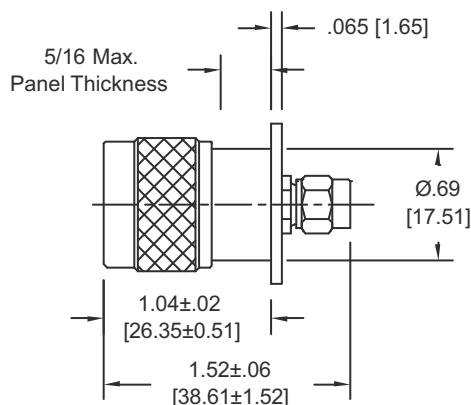

Model Number: **5308**
Type N Male / SMA Female
Length: 1.48 ±.05 [37.59 ±1.27]
Not Shown

Model Number: **5307**
Type N Female / SMA Male
Length: 1.54 ±.05 [39.12 ±1.27]
Not Shown

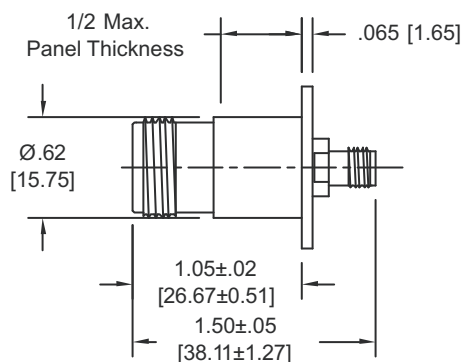

Model Number: **5309**
Type N Female / SMA Female
Length: 1.50 ±.05 [38.1 ±1.27]
As Pictured

HOW TO ORDER:

Model Number: **530X-YYY**

Base Number _____ Frequency Range
= DC - 18 GHz
067 = DC - 6 GHz

Ordering Examples:

Model Number: **5307**
DC - 18 GHz; Type N Fem/SMA Male

Model Number: **5306-067**
DC - 6 GHz; Type N Male/SMA Male

Note: Dimensions in Brackets are Expressed in Millimetres and are for Reference Only
Type N male connectors can be supplied with coupling nuts unattached to aid in installation
Units featuring very low return loss (VSWR) are also available

5306: REV C

AEROFLEX
INMET

Aeroflex / Inmet, Inc. • 300 Dino Drive, Ann Arbor, MI 48103 • U.S.A.
888-244-6638 or 734-426-5553 • FAX: 734-426-5557
www.aeroflex-inmet.com • inmet@aeroflex.com