

- 1.0 PERFORMANCE
- 1.1 FREQUENCY RANGE:DC-18 GHz
- 1.2 DWV:1000V RMS
- 1.3 TEMPERATURE RANGE:-55° C TO +145° C
- 1.4 NOMINAL IMPEDANCE: 50 OHMS
- 1.5 INSULATION RESISTANCE: 10000M OHMS

- 2.0 MATERIALS
- 2.1 DIELECTRIC: PTFE
- 2.2 CENTER CONTACT: BeCu ASTM B196
- 2.3 BODY AND NUT: BRASS ASTM B16
- 2.4 LOCKWASHER: Mn-STEEL
- 3.0 FINISHES
- 3.1 CENTER CONTACT: GOLD PLATED 30 MICROINCHES THICKNESS.
- 3.2 ALL OTHER METAL PARTS: GOLD PLATED 10 MICROINCHES THICKNESS.

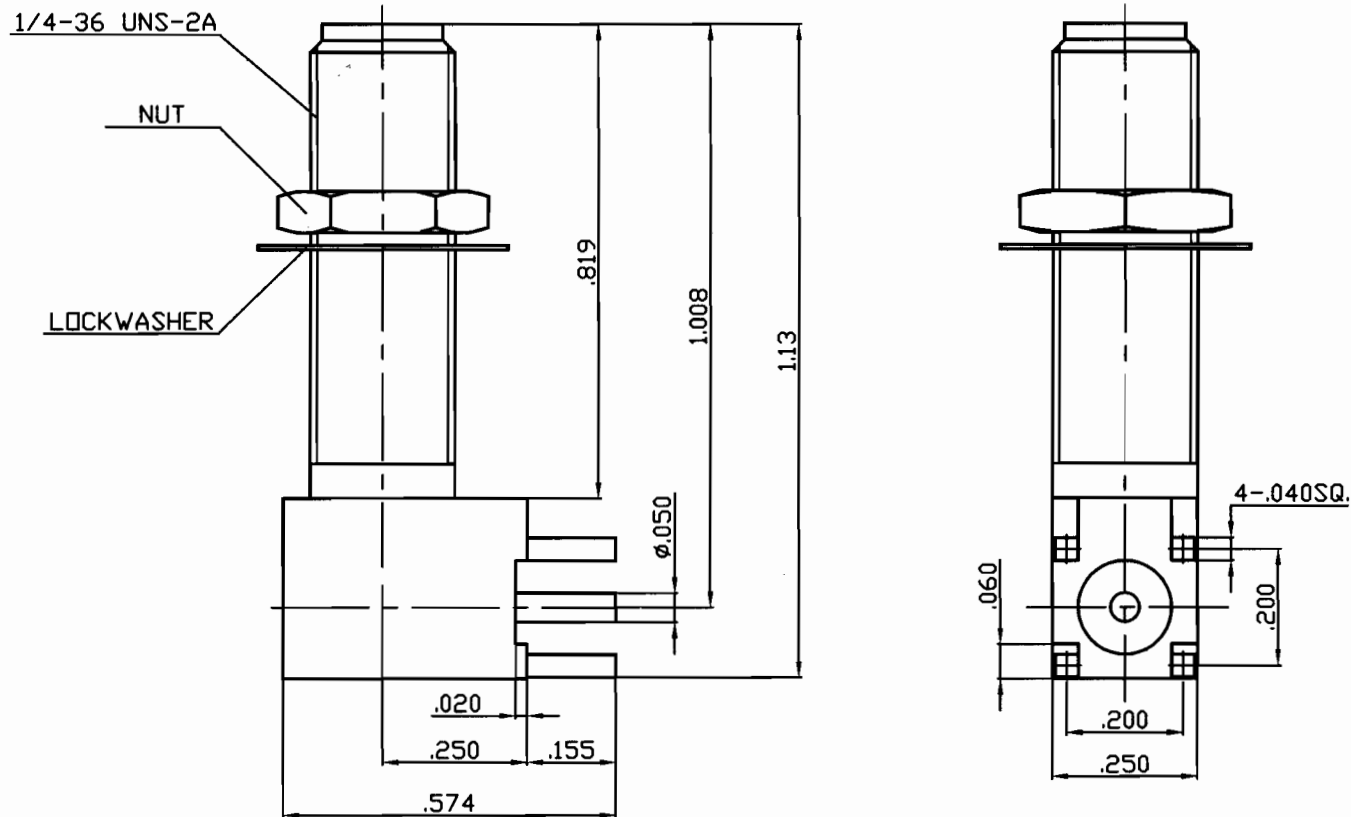

THIS DRAWING CONTAINS CONFIDENTIAL INFORMATION  
PROPRIETARY TO SDT INC. IT MUST NOT BE REPRODUCED OR  
DISCLOSED TO OTHERS OR USED IN ANY OTHER WAY IN WHOLE  
OR PART EXCEPT AS AUTHORIZED IN WRITING BY SDT  
INCORPORATED.

UNLESS OTHERWISE SPECIFIED:  
ALL DIMENSIONS ARE IN INCHES.  
ALL DIMENSIONS ARE AFTER PLATING.  
XXX=.005 ALL MACHINED SURFACES ✓ MAX.  
XX=.01 ANG. 1/2; FRACTIONAL = 1/84

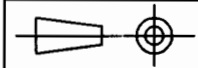

THIRD ANGLE PROJECTION

DWN	YHJ	08/08/05
CHKD	SJG	08/08/05
APPR	SJG	08/08/05

Shanghai SDT Inc.

No.4Lane 1175Tongpu Rd.,Shanghai,China,200333

Fax:021-52701318; Tel:52701316; Email:sdpshe@sh163.net

TITLE

SMA RIGHT ANGLE BULKHEAD JACK

MATERIAL:

FINISH:

DO NOT SCALE  
DRAWING

DWG NO.

SDT22335-0B

REV.  
0