

1.0 PERFORMANCE

- 1.1 FREQUENCY RANGE: DC-11GHZ
- 1.2 VOLTAGE RANGE:1000V RMS (sea level)
- 1.3 DWV: 2500V RMS
- 1.4 TEMPERATURE RANGE:-55° C TO +155° C
- 1.5 NOMINAL IMPEDANCE: 50OHMS
- 1.6 INSULATION RESISTANCE: 5000 MOHMS

2.0 MATERIALS

- 2.1 DIELECTRIC: PTFE
- 2.2 CENTER CONTACT: BRASS B-16 (ASTM)
- 2.3 BODY AND NUT: BRASS B-16 (ASTM)
- 3.0 FINISHES
- 3.1 CENTER CONTACT: GOLD PLATED 30 MICROINCHES THICKNESS
- 3.2 ALL OTHER METAL PARTS: NICKEL PLATED 100 MICROINCHES THICKNESS

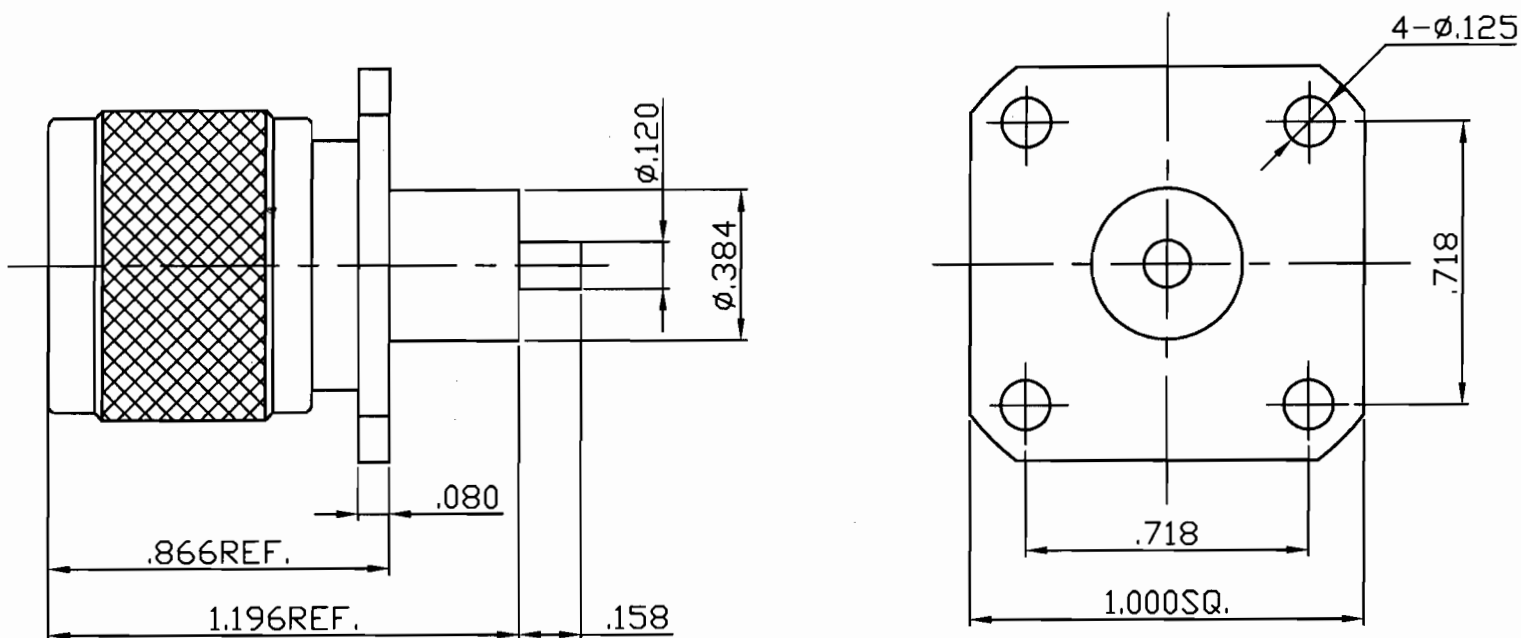

THIS DRAWING CONTAINS CONFIDENTIAL INFORMATION PROPRIETARY TO SDT INC. IT MUST NOT BE REPRODUCED OR DISCLOSED TO OTHERS OR USED IN ANY OTHER WAY IN WHOLE OR PART EXCEPT AS AUTHORIZED IN WRITING BY SDT INCORPORATED.

UNLESS OTHERWISE SPECIFIED:
ALL DIMENSIONS ARE IN INCHES.
ALL DIMENSIONS ARE AFTER PLATING.
.XXX=.005 ALL MACHINED SURFACES $\sqrt{\text{MAX}}$.
.XX= .01 ANG 1/2° FRACTIONAL=1/64

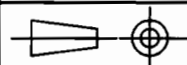

THIRD ANGLE PROJECTION

DWN	YHJ	10/10/05
CHKD	SJG	10/10/05
APPR	SJG	10/10/05

Shanghai SDT Inc.
No.4Lane 1175Tongpu Rd.,Shanghai,China,200333
Fax:021-52701318; Tel:52701316; Email:sdpshe@sh163.net

TITLE

TYPE N PANEL MOUNT PLUG

MATERIAL:

FINISH:

DO NOT SCALE
DRAWING

DWG NO.

SDT31404-3

REV.
0