

# DC BLOCKS

SMA, 10 MHz - 18 GHz, Inner Only

## SPECIFICATIONS:

Models: 8055, 8055H, 8056, 8056H, 8057, 8057H

**RoHS**  
Compliant

### Electrical:

Frequency Range \_\_\_\_\_ 10 MHz - 18 GHz  
VSWR \_\_\_\_\_ 1.35:1 Max.  
Impedance \_\_\_\_\_ 50 Ohms  
Insertion Loss \_\_\_\_\_ 0.5 dB Max.  
Voltage Rating \_\_\_\_\_ 200 Volts  
Operating Temp. Range \_\_\_\_\_ -65°C to +125°C

### Mechanical:

Connectors \_\_\_\_\_ Passivated Stainless Steel  
Mates with MIL-STD-348 \_\_\_\_\_  
Conductors \_\_\_\_\_ Gold Plated Beryllium Copper

**AEROFLEX**  
A passion for performance.

Model Number: **8055**

Male / Female Connectors

Length = .855 ±.020 [21.72 ±0.51]

Pictured

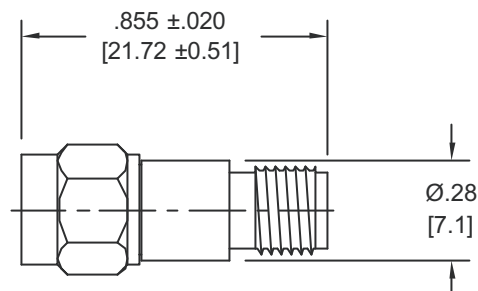

Model Number: **8056**

Female / Female Connectors

Length = .865 ±.015 [21.97 ±0.38]

Model Number: **8057**

Male / Male Connectors

Length = .980 ±.025 [24.89 ±0.64]

Model Number: **8055H**

Male / Female Connectors

Length = .855 ±.020 [21.72 ±0.51]

Pictured

Model Number: **8056H**

Female / Female Connectors

Length = .865 ±.015 [21.97 ±0.38]

Model Number: **8057H**

Male / Male Connectors

Length = .980 ±.025 [24.89 ±0.64]

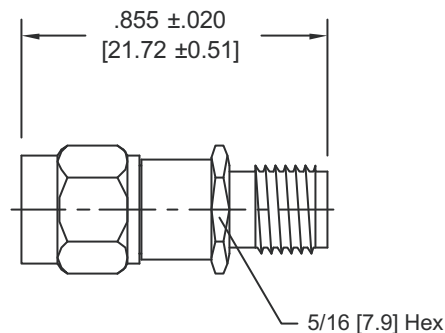

Note: Dimensions in Brackets are Expressed in Millimeters and are for Reference Only.

8055: REV F

**AEROFLEX**  
INMET

Aeroflex / Inmet, Inc. • 300 Dino Drive, Ann Arbor, MI 48103 • U.S.A.  
888-244-6638 or 734-426-5553 • FAX: 734-426-5557  
www.aeroflex-inmet.com • inmet-sales@aeroflex.com