

DC BLOCKS

2.9mm, 10 MHz - 26.5 GHz, 200 Volts

SPECIFICATIONS:

Models: 8062A

RoHS
Compliant

Electrical:

Frequency Range _____ 10 MHz - 26.5 GHz
VSWR _____ 1.35:1 Max.
Impedance _____ 50 Ohms
Insertion Loss _____ 0.75 dB Max.
Voltage Rating _____ 200 Volts Max.
Operating Temp. Range _____ -65°C to +125°C

Mechanical:

Connectors _____ Passivated Stainless Steel
Mates both Mechanically and Electrically with
SMA, K* and 3.5mm Series Connectors
Conductors _____ Gold Plated Beryllium Copper
Housing _____ High Temperature Plastic
Weight _____ 5.5 Grams Max.

* K is a Trademark of Anritsu Corp.



Model Number: **8062A**
Inner / Outer

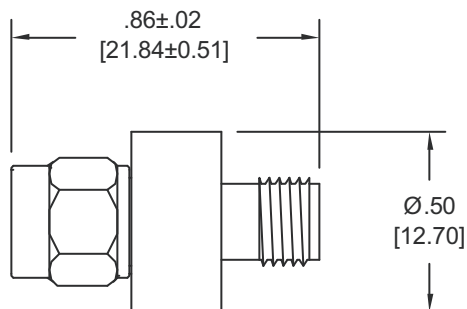

Note: Dimensions in Brackets are Expressed in Millimeters and are for Reference Only.
Design, specifications are subject to change without notice. Contact factory for technical specifications before purchasing and/or use.

8062A: REV -



Aeroflex / Inmet, Inc. • 300 Dino Drive, Ann Arbor, MI 48103 • U.S.A.
888-244-6638 or 734-426-5553 • FAX: 734-426-5557
www.aeroflex-inmet.com • inmet-sales@aeroflex.com