

DC BLOCK SMPM

16 kHz - 50 GHz



MODELS: 8535MP

SPECIFICATIONS:

Electrical:

Frequency Range _____ 16 kHz – 50 GHz

VSWR

10 MHz – 40 GHz _____ 1.50:1 Max.

40 GHz – 50 GHz _____ 2.00:1 Max.

Insertion Loss

10 MHz – 40 GHz _____ 1.50 dB Max.

40 GHz – 50 GHz _____ 2.00 dB Max.

Impedance _____ 50 Ohms

Voltage Rating _____ 10 Volts Max.

Operating Temp. Range _____ -65°C to +125°C

Typical Low Frequency Performance

Frequency Range	Insertion Loss	VSWR
1 kHz	24dB	–
16 kHz	3dB	6:1
50 kHz	0.5dB	2:1
110 kHz	0.1dB	1.35:1

Mechanical:

SMPM Connectors _____ Gold Plated Beryllium Copper
Mates with MIL-STD-348 & GPPO* Connectors

Conductors _____ Gold Plated Beryllium Copper

Housing _____ Gold Plated Beryllium Copper

*GPPO is a trademark of Gilbert Engineering Co., Inc.

Model Number: 8535MP

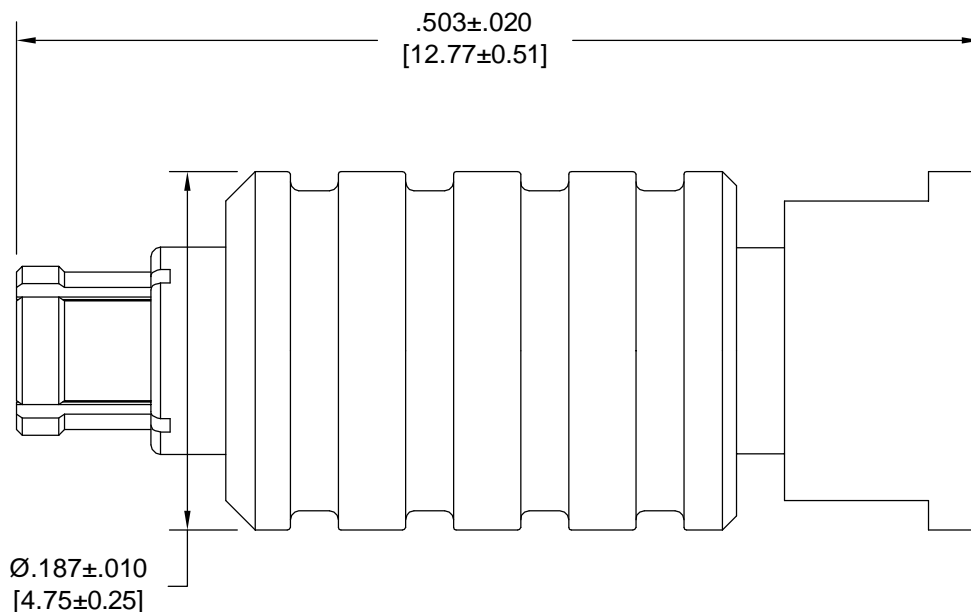

Note: Dimensions in Brackets are Expressed in Millimeters and are for Reference Only.

Design specifications are subject to change without notice.

Contact factory for technical specifications before purchasing or use.

8535MP; REV C

300 Dino Drive • Ann Arbor, MI 48103-9457 U.S.A. • 888-244-6638 or 734-426-5553 • FAX 734-426-5557 • www.inmetcorp.com