

# TERMINATIONS

7/16 - DIN, DC - 7.5 GHz, 25 Watts

## SPECIFICATIONS:

Models: 3112-DF, 3112-DM

**RoHS**  
Compliant

**AEROFLEX**  
A passion for performance.

### Electrical:

Frequency Range \_\_\_\_\_ DC - 7.5 GHz  
VSWR \_\_\_\_\_  
DC - 4 GHz \_\_\_\_\_ 1.25:1 Max.  
4 - 7.5 GHz \_\_\_\_\_ 1.45:1 Max.  
Impedance \_\_\_\_\_ 50 Ohms  
Input Power \_\_\_\_\_ 25 Watts Avg. @ +25°C  
Derated Linearly to 5 Watts @ +125°C  
Peak Power \_\_\_\_\_ 5 kW Max.  
(5uSec Pulse, .05% Duty Cycle)  
Operating Temp Range \_\_\_\_\_ -65°C to +125°C

### Mechanical:

7/16 - DIN Connectors \_\_\_\_\_ Silver Plated Brass  
Mates with DIN 47 223  
Conductors \_\_\_\_\_ Silver Plated Beryllium Copper or Brass  
Housing \_\_\_\_\_ Anodized Aluminum

Model Number: **3112-DF**

7/16 - DIN Female Connector

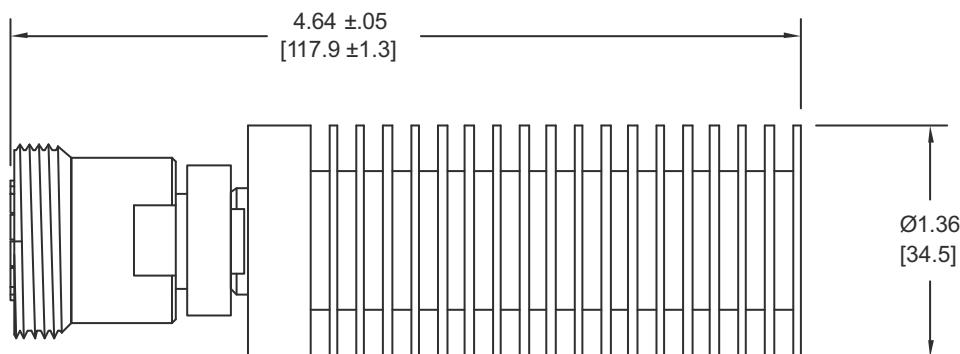

Model Number: **3112-DM**

7/16 - DIN Male Connector

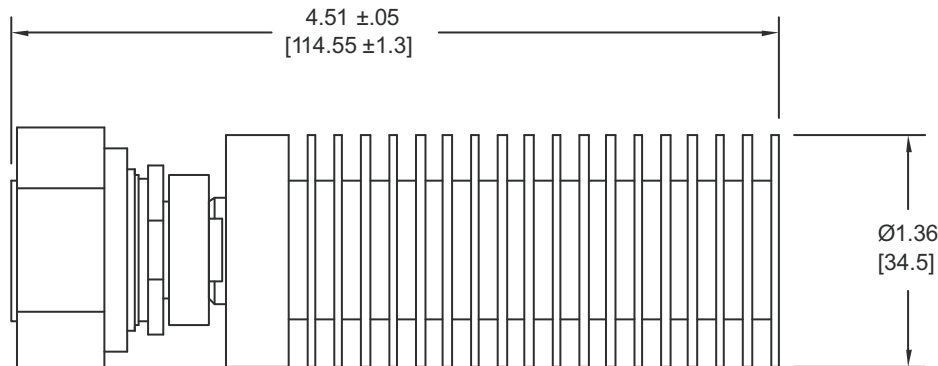

Note: Dimensions in Brackets are Expressed in Millimeters and are for Reference Only.

Design, specifications are subject to change without notice. Contact factory for technical specifications before purchasing and/or use.

3112-D: REV -

**AEROFLEX**  
INMET

Aeroflex / Inmet, Inc. 300 Dino Drive, Ann Arbor, MI 48103 • U.S.A.  
888-244-6638 or 734-426-5553 • FAX: 734-426-5557  
[www.aeroflex-inmet.com](http://www.aeroflex-inmet.com) • [inmet-sales@eroflex.com](mailto:inmet-sales@eroflex.com)