

# TERMINATIONS

BNC, up to 4 GHz, 50 Watts

## SPECIFICATIONS:

Models: TBXXXM-50W, TBXXXF-50W

**RoHS**  
Compliant

### Electrical:

Frequency Range \_\_\_\_\_ DC - 4 GHz  
Standard Freq. Values \_\_\_\_\_ 2.5 & 4 GHz  
VSWR \_\_\_\_\_ 1.25:1 Max.  
Impedance \_\_\_\_\_ 50 Ohms  
Input Power \_\_\_\_\_ 50 Watts Avg. @ +25°C  
Derated Linearly to 10 Watts @ +125°C  
Peak Power \_\_\_\_\_ 500 Watts Max.  
(5uSec Pulse, .05% Duty Cycle)  
Operating Temp Range \_\_\_\_\_ -65°C to +125°C

### Mechanical:

BNC Connectors \_\_\_\_\_ Nickel Plated Brass  
Mates with MIL-STD-348  
Housing \_\_\_\_\_ Anodized Aluminum  
Conductors \_\_\_\_\_ Gold Plated Beryllium Copper or Brass

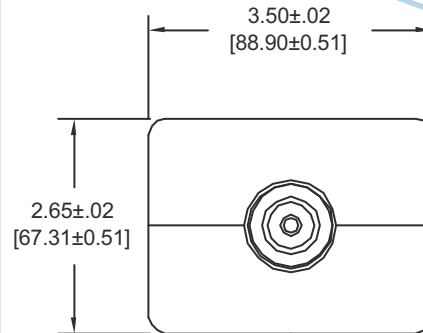

END VIEW  
TYPICAL

Units must be Mounted in such a way as to  
Allow for Free Air Flow Around fins to Insure  
Performance

Model Number: **TBXXXM-50W**

BNC Male Connector

Model Number: **TBXXXF-50W**

BNC Female Connector

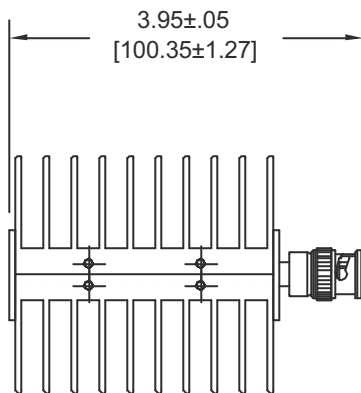

NOTE: Hole Pattern typical for both  
Male & Female units

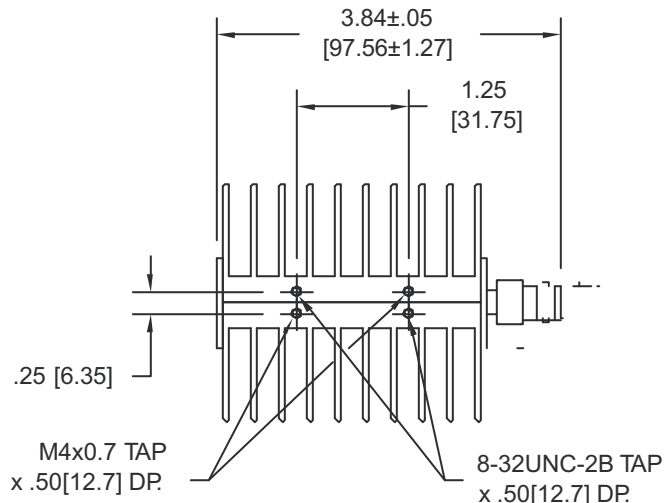

## HOW TO ORDER:

Model Number: **TBXXXy-50W**

Freq. Range \_\_\_\_\_ Connector Configuration  
020 = DC - 2.5 GHz F = Female  
040 = DC - 4 GHz M = Male

### Ordering Examples:

Model Number: **TB020M-50W**  
DC - 2.5 GHz, BNC Male Conn.

Model Number: **TB040F-50W**  
DC - 4 GHz, BNC Female Conn.

Note: Dimensions in Brackets are Expressed in Millimeters and are for Reference Only.  
Design specifications are subject to change without notice.  
Contact factory for technical specifications before purchasing or use.

TB040-50W: REV -



Aeroflex / Inmet, Inc. • 300 Dino Drive, Ann Arbor, MI 48103 • U.S.A.  
888-244-6638 or 734-426-5553 • FAX: 734-426-5557  
www.aeroflex-inmet.com • inmet-sales@eroflex.com