

# TERMINATIONS

7/16 - DIN, up to 7.5 GHz, 50 Watts

## SPECIFICATIONS:

Models: TDXXXM-50W, TDXXXF-50W

**RoHS**  
Compliant

**AEROFLEX**  
A passion for performance.

### Electrical:

Frequency Range \_\_\_\_\_ DC - 7.5 GHz  
Standard Freq. Values \_\_\_\_\_ 2.5, 4 & 7.5 GHz  
VSWR \_\_\_\_\_  
DC - 4 GHz \_\_\_\_\_ 1.25:1 Max.  
4 - 7.5 GHz \_\_\_\_\_ 1.45:1 Max.  
Impedance \_\_\_\_\_ 50 Ohms  
Input Power \_\_\_\_\_ 50 Watts Avg. @ +25°C  
Derated Linearly to 10 Watts @ +125°C  
Peak Power \_\_\_\_\_ 500 Watts Max.  
(5uSec Pulse, .05% Duty Cycle)  
Operating Temp Range \_\_\_\_\_ -65°C to +125°C

### Mechanical:

7/16 - DIN Connectors \_\_\_\_\_ Silver Plated Brass  
Mates with DIN 47 223  
Conductors \_\_\_\_\_ Silver Plated Beryllium Copper  
Housing \_\_\_\_\_ Anodized Aluminum

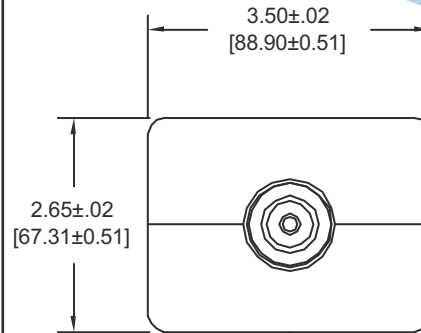

END VIEW  
TYPICAL

Units must be Mounted in such a way as to  
Allow for Free Air Flow Around fins to Insure  
Performance

Model Number: **TDXXXM-50W**  
7/16 - DIN Male Connector

Model Number: **TDXXXF-50W**  
7/16 - DIN Female Connector

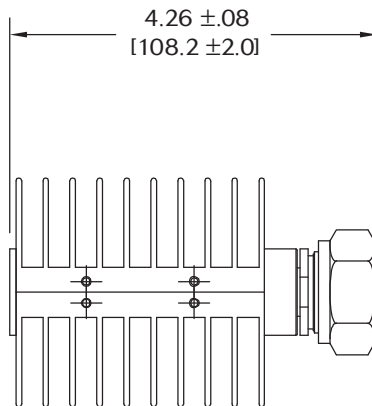

NOTE: Hole Pattern typical for both  
Male & Female units

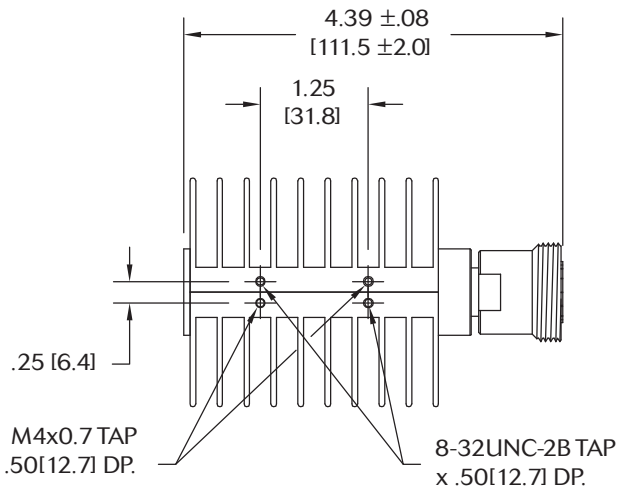

Items in Catalog are Subject to Change Without Notice

## HOW TO ORDER:

Model Number: **TDXXXY-50W**

Freq. Range \_\_\_\_\_ Connector Configuration \_\_\_\_\_  
020 = DC - 2.5 GHz F = Female  
040 = DC - 4 GHz M = Male  
075 = DC - 7.5 GHz

### Ordering Examples:

Model Number: **TD020M-50W**  
DC - 2.5 GHz, 7/16-DIN Male Conn

Model Number: **TD075F-50W**  
DC - 7.5 GHz, 7/16-DIN Female Conn.

Note: Dimensions in Brackets are Expressed in Millimeters and are for Reference Only.  
Design, specifications are subject to change without notice. Contact factory for technical  
specifications before purchasing and/or use.

TD075-50W: REV J

**AEROFLEX**  
INMET

Aeroflex / Inmet, Inc. • 300 Dino Drive, Ann Arbor, MI 48103 • U.S.A.  
888-244-6638 or 734-426-5553 • FAX: 734-426-5557  
www.aeroflex-inmet.com • inmet-sales@eroflex.com