

TERMINATIONS

7/16 - DIN, up to 7.5 GHz, 25 Watts

SPECIFICATIONS:

Models: TDXXXM-25W, TDXXXF-25W

RoHS
Compliant

Electrical:

Frequency Range _____ DC - 7.5 GHz
Standard Freq. Values _____ 2.5, 4 & 7.5 GHz
VSWR _____
DC - 6 GHz _____ 1.20:1 Max.
6 - 7.5 GHz _____ 1.30:1 Max.
Impedance _____ 50 Ohms
Input Power _____ 25 Watts Avg. @ +25°C
Derated Linearly to 5 Watts @ +125°C
Peak Power _____ 500 Watts Max.
(5uSec Pulse, .05% Duty Cycle)
Operating Temp Range _____ -65°C to +125°C

Mechanical:

7/16 - DIN Connectors _____ Silver Plated Brass
Mates with DIN 47 223
Conductors _____ Silver Plated Beryllium Copper
Housing _____ Anodized Aluminum

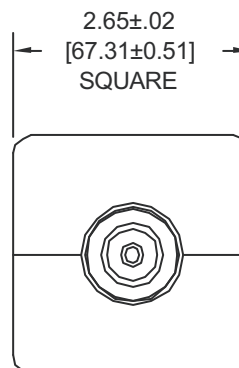

END VIEW
TYPICAL

Units must be Mounted in such a way as to
Allow for Free Air Flow Around fins to Insure
Performance

Model Number: TD075M-25W

7/16 - DIN Male Connector

Model Number: TD075F-25W

7/16 - DIN Female Connector

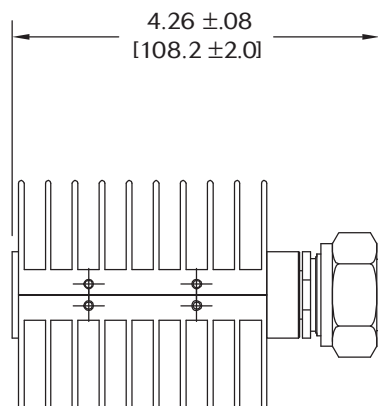

NOTE: Hole Pattern typical for both
Male & Female units

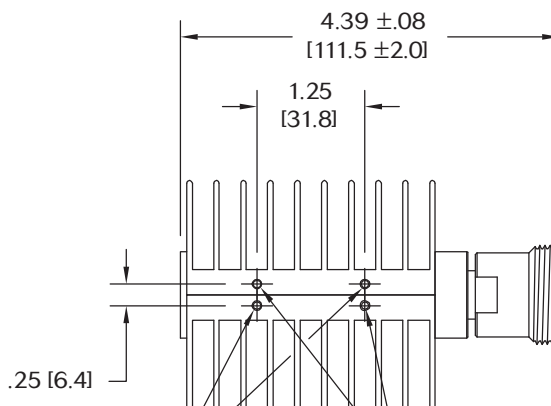

M4x0.7 TAP
x .50 [12.7] DP.

8-32UNC-2B TAP
x .50 [12.7] DP.

HOW TO ORDER:

Model Number: **TDXXxy-25W**

Freq. Range _____ Connector Configuration
020 = DC - 2.5 GHz F = Female
040 = DC - 4 GHz M = Male
075 = DC - 7.5 GHz

Ordering Examples:

Model Number: **TD040M-25W**
DC - 4 GHz, DIN 7/16 Male

Model Number: **TD075F-25W**
DC - 7.5 GHz, DIN 7/16 Female

Note: Dimensions in Brackets are Expressed in Millimeters and are for Reference Only.

TD075-25W: REV G



Aeroflex / Inmet, Inc. • 300 Dino Drive, Ann Arbor, MI 48103 • U.S.A.
888-244-6638 or 734-426-5553 • FAX: 734-426-5557
www.aeroflex-inmet.com • inmet-sales@aeroflex.com