



SMB / SMB-LOCK / SMC

R114 / R115 / R116 / R117 / R112

Contents

SMB

Introduction 7-4 to 7-5
Interface 7-6
Characteristics 7-7 to 7-8
Plugs 7-8 to 7-9
Jacks 7-9 to 7-10
Bulkhead jacks 7-10 to 7-11
Receptacles 7-11 to 7-12
PCB receptacles 7-13
Adapters 7-13

SMB-LOCK

Introduction 7-14
Interface 7-14
Characteristics 7-15
Plugs 7-16

SMB Limited detent (SMB-A)

Receptacles 7-16 to 7-17

SMB Slide-on (SUBGLIS)

Plugs 7-17
Receptacles 7-17
Panel drilling 7-18
Assembly instructions 7-18

SMC

Introduction 7-19
Interface 7-19
Characteristics 7-20
Plugs 7-21
Jacks 7-21 to 7-22
Receptacles 7-22 to 7-23
Adapters 7-23
Panel drilling 7-23

SECTION 7 TABLE OF CONTENTS

Introduction

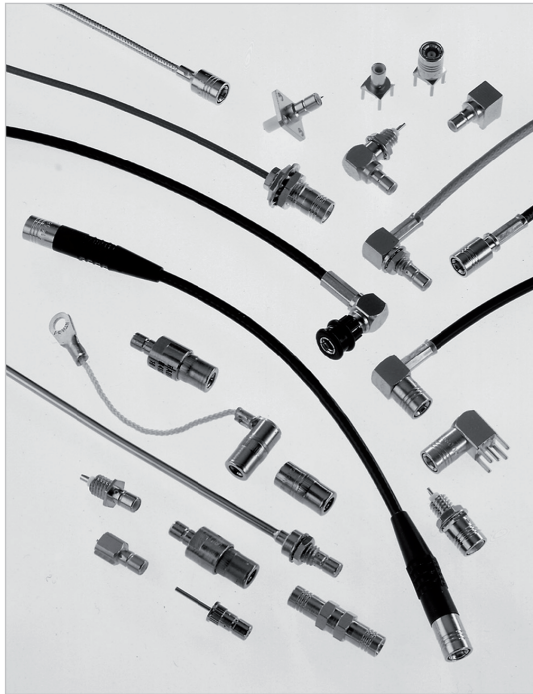

50Ω

DC - 4 GHz

GENERAL

- Subminiature coaxial connectors
- Snap-on coupling
- Plugs have female contacts
- Jacks have male contacts
- Low weight and reduced outline dimensions
- Captive contact (except contrary specification)

APPLICABLE STANDARDS

- SMB series MIL-C-39012
MIL-C-39012/67-72
- IEC 169-10
- CECC 22130
- BS 9210 N0007

APPLICATIONS

- Mobile communication systems
- Civil and military telecommunications
- Aeronautics
- Automotive

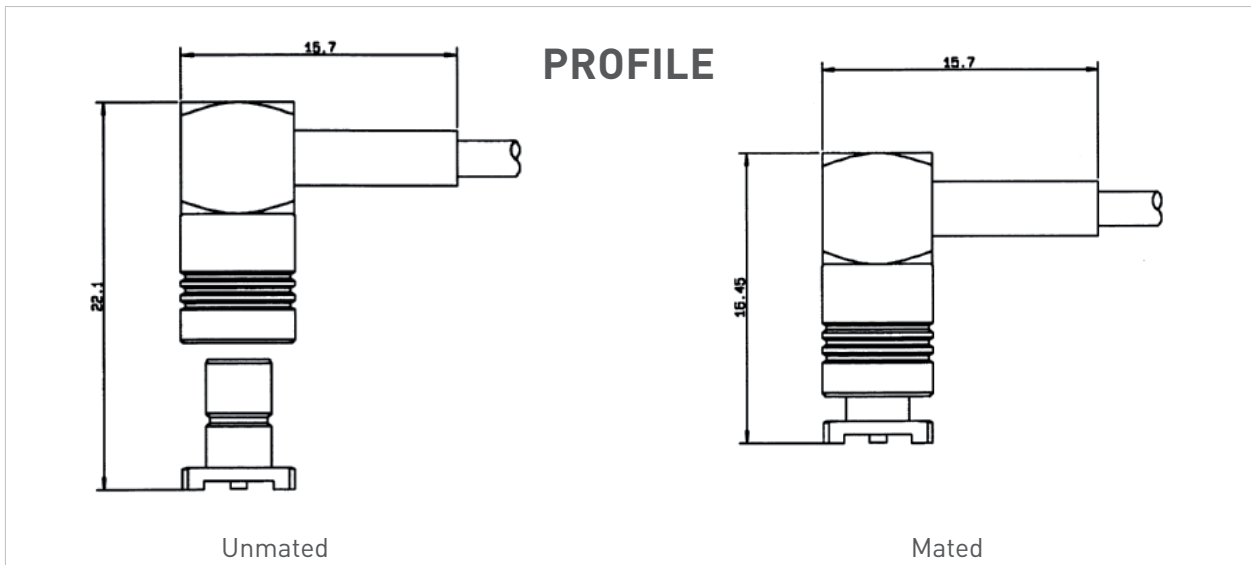

Introduction

The SMB snap-on subminiature coaxial connectors provide a fast and reliable connection for high density packaging for applications up to 4 GHz.

Radiall offers a very large range of SMB connectors, including cable plugs and jacks with bulkhead and panel mount configurations, bulkhead and panel mount receptacles; through hole, SMT and edge card receptacles and in-series and between series adapters.

The SMB series also features versions with lower mating forces than standard. Four types of interconnection mechanisms are available:

- **SMB: standard** snap-on connection

The design permits quick engagement and disengagement.

- **SMB limited detent (SMB-A):** snap-on connection with **low mating force**

The design permits quick engagement and disengagement and is suitable for printed circuit boards.

Radiall offers a range of PCB and bulkhead receptacles with female center contact.

The SMB-A receptacles are completely intermateable with standard SMB jacks.

- **SMB slide-on (SUBGLIS):** slide-on connection

The design is suitable for back plane and blind mate applications. In this case, we recommend the association of a mobile connector (floating jack / receptacle) with a fixed connector (panel plug / jack, receptacle).

The SUBGLIS connectors are completely intermateable with standard SMB and SMB-A connectors and for that, they can be used for test applications.

- **SMB Lock:**

Plugs (with female center contact) have a coupling nut allowing a reliable lock-on connection (50 N min). This range allows a visual control of the locking system.

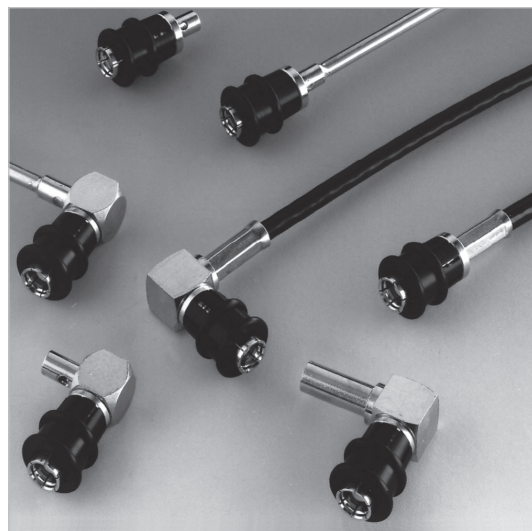

These four types of SMB connectors have the same electrical performances.

Interface

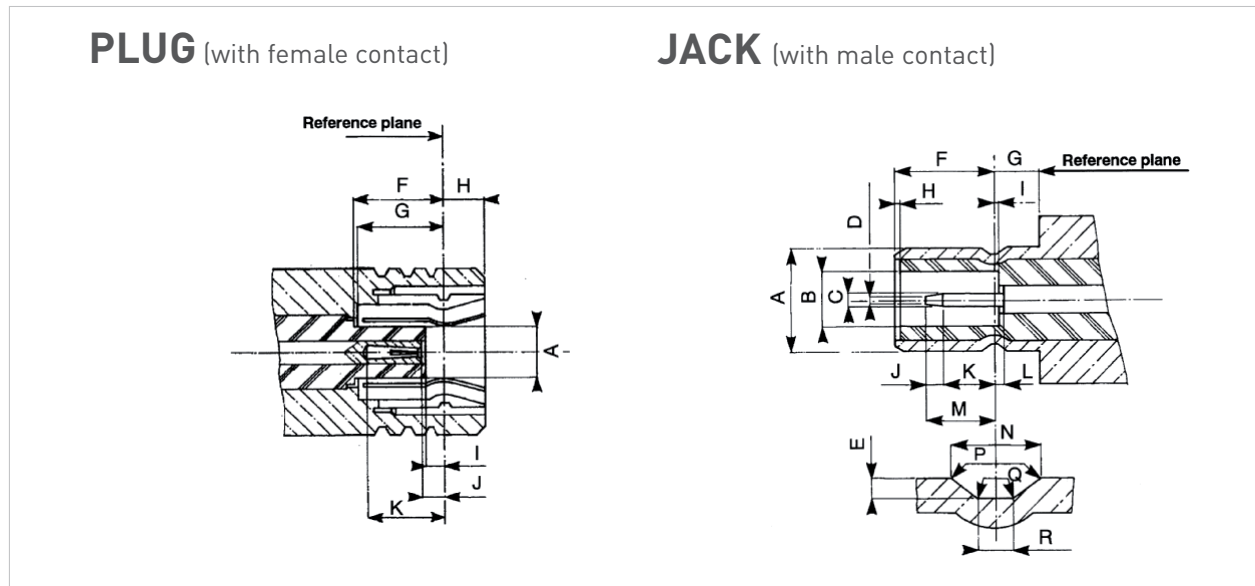

Letter	mm		inch	
	min.	max.	min.	max.
A DIA		2.06		.081
F	3.58		.141	
G	3.58		.141	
H		1.63		.064
I	0.18		.007	
J	0.18	0.94	.007	.037
K	2.97		.117	

Letter	mm		inch	
	min.	max.	min.	max.
A DIA		3.71		.146
B DIA	2.08		.082	
C DIA	0.48	0.53	.019	.021
D DIA		0.25		.010
E	0.15	0.25	.006	.010
F	3.33	3.58	.131	.141
G	1.65		.065	
I		0.18		.007
J	0.25		.010	
K	1.32		.052	
L		0.18		.007
M		2.97		.117
N	0.69	0.94	.027	.037
P	0.05	0.15	.002	.006
Q		0.13		.005
R	0.28	0.38	.011	.015

CLAMP TYPE CONNECTORS: R 114 xxx 000 = braid retention with cylindrical gasket
 R 114 xxx 133 = braid retention with V groove gasket

Characteristics

Test/characteristics	MIL-C-39012 A	Values/remarks
----------------------	---------------	----------------

ELECTRICAL CHARACTERISTICS

Impedance		50Ω		
Frequency range		DC - 4 GHz		
V.S.W.R. (typ.)	Frequency	1 GHz	2.5 GHz	4 GHz
Straight models	cable group: .085"	1.12	1.22	1.33
	2	1.10	1.22	1.33
Right angle models	.085"	1.12	1.22	1.35
	2	1.10	1.18	1.26
			1.20	1.25
Insertion loss (typ.) dB		3-27		
Straight models	cable group: .085"	0.05	0.07	0.15
	2	0.05	0.10	0.25
Right angle models	.085"	0.05	0.05	0.05
	2	0.05	0.07	0.12
RF leakage		3-26		
Insulation resistance		3-11		
Contact resistance		3-16		
		Initial	After test	
• center contact (mΩ)		6	8	
• outer contact (mΩ)		1	1.5	
Working voltage				
• cable group		2/50	2.6/50	
• at sea level		250 V rms	335 V rms	
• at 70000 ft (21000 m)		60 V rms	85 V rms	
Dielectric withstanding voltage		3-17		
• cable group		2/50	2.6/50	
• at sea level		750 V rms	1000 V rms	
• at 70000 ft (21000 m)		185 V rms	250 V rms	
RF withstanding voltage (5 MHz sine wave)		3-23		
• cable group		2/50	2.6/50	
• at sea level		500 V rms	700 V rms	

MECHANICAL CHARACTERISTICS

Durability	3-15	500 matings
Mating / unmating	3-5-1	Axial force: 62 N max (14 Lbf)
Cabling retention force	3-24	58 N (13Lbf) 110 N (25Lbf)
Center contact retention		Axial: 10 N (2.25 Lbf)

ENVIRONMENTAL CHARACTERISTICS

Temperature range		-65°C / + 165°C
standard models		-65°C / +165°C
hermetic sealed models		-65°C / +105°C
models for semi-rigid cables		
Combined climate tests		MIL-STD-202, method 102, condition C
Thermal shock	3-20	MIL-STD-202, method 107, condition B
High temperature endurance		MIL-STD-202, method 108
Corrosion (salt spray)	3-13	MIL-STD-202, method 101, condition B, 5%
Vibrations	3-18	MIL-STD-202, method 204, condition B, 15g
Shocks	3-19	MIL-STD-202, method 213, condition B, 75g
Low pressure	3-22	MIL-STD-202, method 105, condition C
Hermetic seal		Applied vacuum 10 ⁻⁶ mm of Hg (Torrs) Leakage rate < 10 ⁻⁶ atm/cm ² /s

MATERIALS AND PLATING

	Material	Plating
Body and center pin contact	Half hard brass as per QQ-B-626	Gold or nickel (Body)
Center socket contact	Beryllium copper as per QQ-C-530	Gold (Center contact)
Ferrules	Brass	
Insulators	PTFE teflon	
Gaskets	Silicone elastomer	

Standard packaging: 100 pieces.

All dimensions are given in mm

Characteristics

POWER RATING

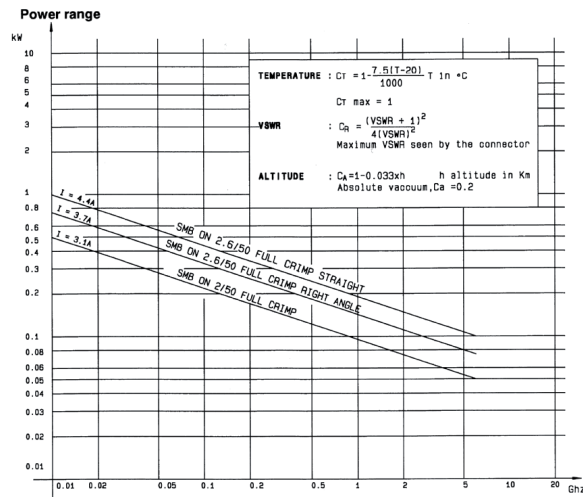

Plugs

STRAIGHT PLUGS CRIMP TYPE FOR FLEXIBLE CABLES

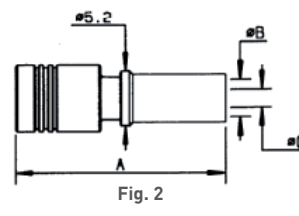
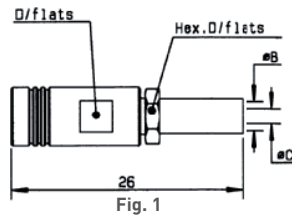

Cable group	Cable group dia.	Part number	Fig	Dimensions mm				Captive center contact	Finish	Note
				A	B	C	D			
RG178/RG196	2/50/S	R114 073 000	1		2.55	0.95	5	yes	Gold	
RG174/RG316/RG179	2.6/50+75/S	R114 075 000		19.8	3.25	1.7				
RD316	2.6/50/D	R114 083 000	2	18.8						full crimp

STRAIGHT PLUGS

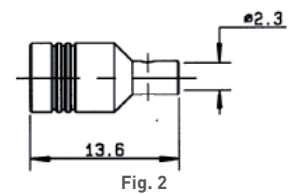
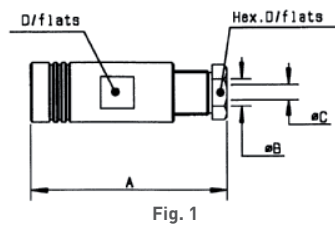

Cable group	Cable group dia.	Part number	Fig	Dimensions mm				Captive center contact	Finish	Note
				A	B	C	D			
RG178/RG196	2/50/S	R114 003 000	1	21.8	2.2	0.95	5	yes	Gold	clamp type for flexible cable
RG174/RG316/RG179	2.6/50+75/S	R114 005 000			3	1.7				
RG405	.085"	R114 053 000	2					no		solder type for semi rigid cable

Plugs and jacks

RIGHT ANGLE PLUGS CRIMP TYPE FOR FLEXIBLE CABLES

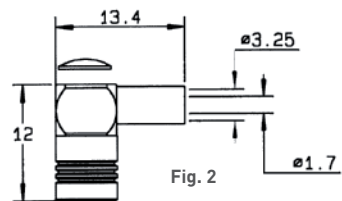
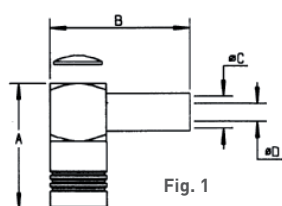

Cable group	Cable group dia.	Part number	Fig	Dimensions mm				Captive center contact	Finish	Note
				A	B	C	D			
RG178/RG196	2/50/S	R114 183 000	1	13.8	15.7	2.55	0.95	yes	Gold	
RG174/RG316/RG179	2.6/50+75/S	R114 185 000	2							short version
		R114 186 000	1	13.8	15.7	3.25	1.7			
		R114 186 100			15.3		1.72			
		R114 187 000		15.1	15.7		1.7			full crimp
RD316	2.6/50/D	R114 182 000		13.8						

RIGHT ANGLE PLUGS

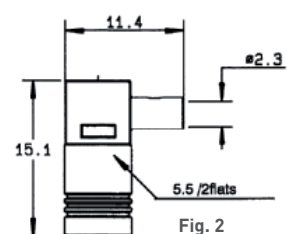
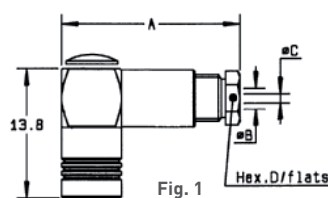

Cable group	Cable group dia.	Part number	Fig	Dimensions mm				Captive center contact	Finish	Note
				A	B	C	D			
RG178/RG196	2/50/S	R114 163 000	1	19	2.2	1	5	yes	Gold	clamp type for flexible cables
	2.2/50/D	R114 163 420		16.7	2.5		6			
RG174/RG316/RG179	2.6/50+75/S	R114 165 000		19	3	1.7	5			cable bending required solder type for semi rigid cable
RG405	.085"	R114 169 000	2							

STRAIGHT JACKS CRIMP TYPE FOR FLEXIBLE CABLES

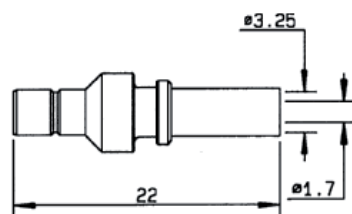

Cable group	Cable group dia.	Part number	Fig	Dimensions mm			Captive center contact	Finish	Note
				A	B	C			
RG174/RG316/RG179	2.6/50+75/S	R114 238 000	2				yes	Gold	full crimp

Jacks and bulkhead jacks

STRAIGHT JACKS CLAMP TYPE FOR FLEXIBLE CABLES

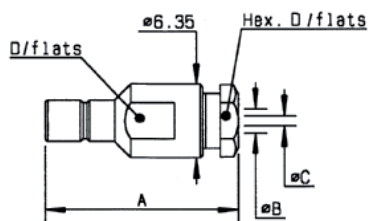

Cable group	Cable group dia.	Part number	Dimensions mm				Captive center contact	Finish
			A	B	C	D		
RG178/RG196	2/50/S	R114 203 000	21	2.2	1	5	yes	Gold
RG174/RG316/RG179	2.6/50+75/S	R114 205 000		3	1.7			

STRAIGHT BULKHEAD JACKS CRIMP TYPE FOR FLEXIBLE CABLES

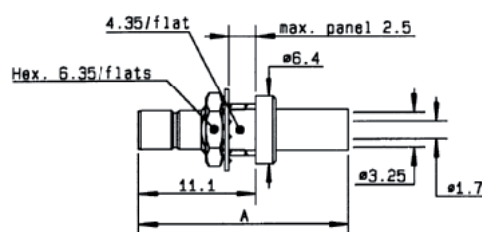

Cable group	Cable group dia.	Part number	Dimensions mm	Captive center contact	Panel drilling	Finish	Note
			A				
RG174/RG316/RG179	2.6/50+75/S	R114 313 000	22	yes	P08	Gold	rear mount/full crimp

STRAIGHT BULKHEAD JACKS CLAMP TYPE FOR FLEXIBLE CABLES

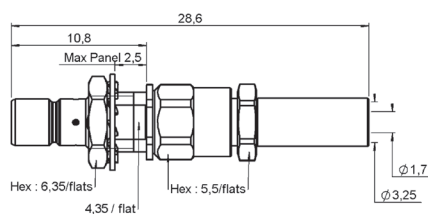

Fig. 1

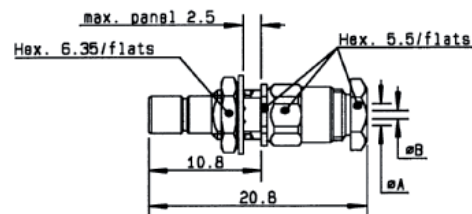
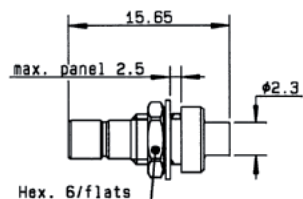

Fig. 2

Cable group	Cable group dia.	Part number	Fig	Dimensions mm		Captive center contact	Panel drilling	Finish	Note
				A	B				
RG178/RG196	2/50/S	R114 303 000	1	2.2	1	yes	P08	Gold	conical braid clamp
		R114 303 133	2						
RG174/RG316/RG179	2.6/50+75/S	R114 305 000	1	3	1.7				

Bulkhead jacks and receptacles

STRAIGHT BULKHEAD JACK SOLDER TYPE FOR SEMI-RIGID CABLE



Cable group	Cable group dia.	Part number	Captive center contact	Panel drilling	Finish
RG405	.085"	R114 222 000	yes	P08	Gold

STRAIGHT FLANGE RECEPTACLES (male center contact)

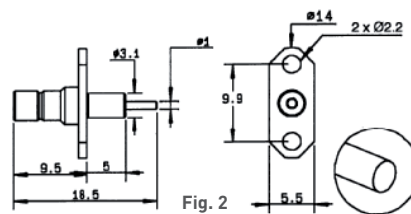
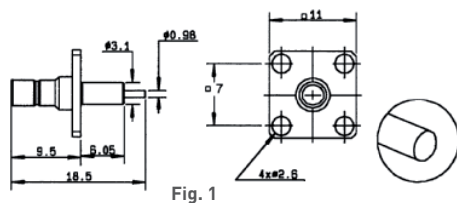

Part number	Fig	Captive center contact	Panel drilling	Finish	Note
R114 413 000	1	no	P01	Gold	square flange / extended dielectric
R114 450 000	2		P06		2 hole flange / extended dielectric / unit packaging

STRAIGHT BULKHEAD RECEPTACLES (male center contact)

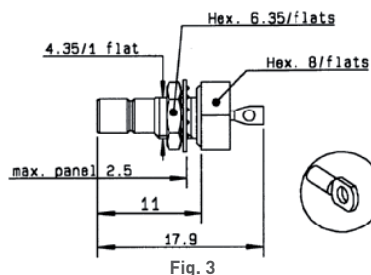
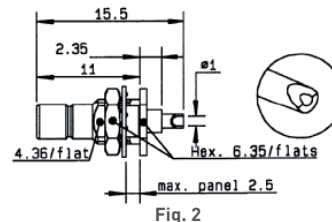
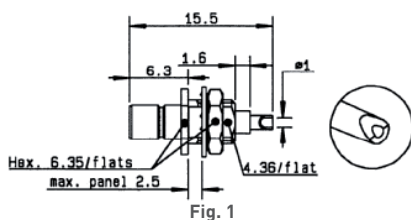

Part number	Fig	Captive center contact	Panel drilling	Finish	Note
R114 553 000	1	yes	P08	Gold	front mount
R114 554 000	2				rear mount
R114 603 000	3				hermetically sealed

Receptacles

STRAIGHT PRESS IN RECEPTACLE (male)

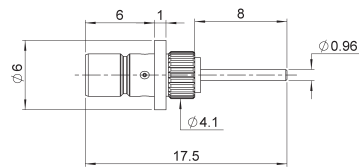

Part number	Captive center contact	Panel drilling	Finish
R114 504 225	yes	P10	Nickel

RIGHT ANGLE BULKHEAD RECEPTACLES (male center contact)

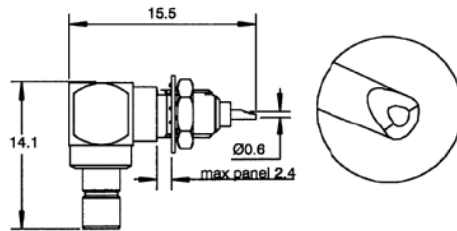

Part number	Captive center contact	Panel drilling	Finish
R114 670 000	yes	P08	Gold

STRAIGHT PCB RECEPTACLES

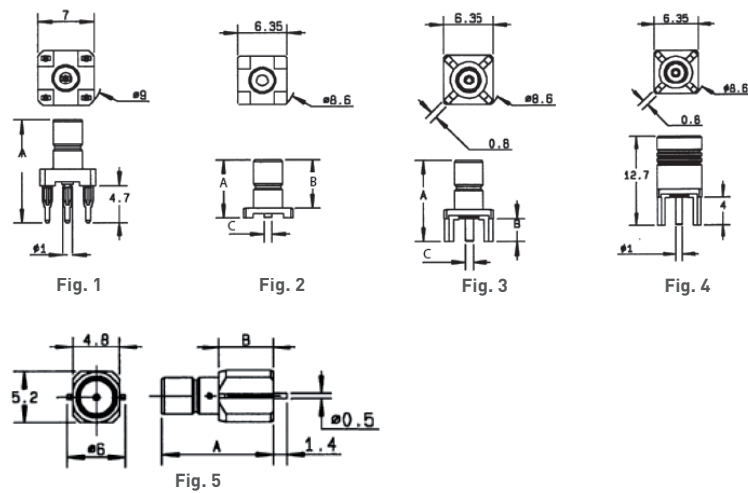

Part number	Fig	Dimensions mm			Captive center contact	Assembly instructions	Panel drilling	Finish	Note
		A	B	C					
R114 416 020	1	12.85			yes		P02	Nickel	press fit pins
R114 423 000	5	11.5	5.5			M01		Gold	SMT edge card
R114 424 000	2	7.4	6.15	0.96		M01			SMT
R114 424 100	2	7.4	6.15	0.96		M01			SMT / packaging 100 reel
R114 425 000	4						P05		female
R114 426 000	3	11.4	4	0.8			P03		

PCB receptacles

RIGHT ANGLE PCB RECEPTACLES (male center contact)

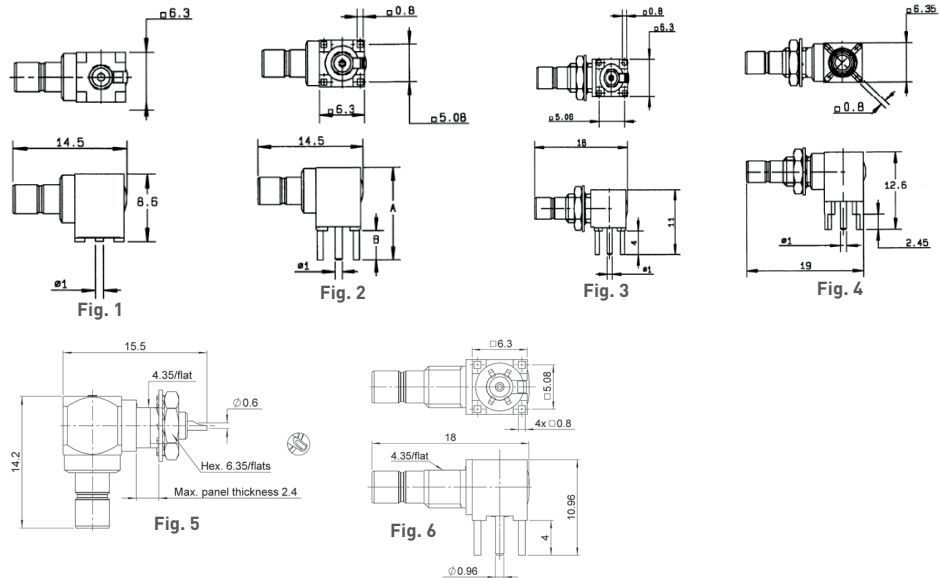
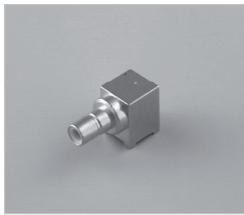

Part number	Fig	Dimensions mm		Captive center contact	Assembly instructions	Panel drilling	Finish	Note
		A	B					
R114 664 000	1			yes	M01	Gold	packaging 100p reel	
R114 664 120							SMT / packaging 500p reel	
R114 665 000	2	12.6	4		P03	Nickel	packaging unit rear mount	
R114 665 020								
R114 673 020	3				P08	Gold	packaging 100 pieces	
R114 673 120	4						packaging 200 pieces	
R114 670 000	5							
R114 673 823	6				P09			

Adapters

IN SERIES ADAPTERS

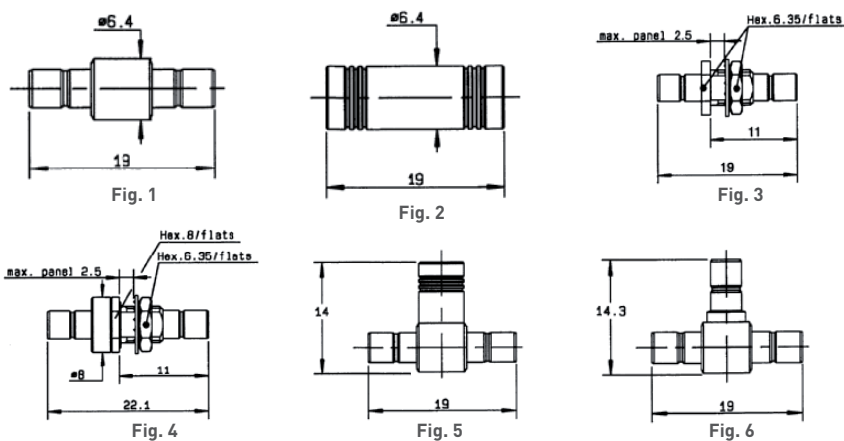

Part number	Fig	Captive center contact	Panel drilling	Finish	Note
R114 703 000	1	yes	P08	Gold	male - male
R114 704 000	2				female - female
R114 720 000	3				bulkhead male - male
R114 753 000	4				hermetically sealed male - male
R114 780 000	5				tee female / male - male
R114 781 000	6				tee male / male - male

SMB LOCK

Introduction

RADIALL proposes new **SMB LOCK** plugs with a 2 step connection system:

- 1 **Snap** the plug on the male connector (fig. 1)
- 2 **Lock** the couple by pushing down the coupling nut (fig. 2)

This new range

- is **totally intermateable** with the standard **SMB** male connectors,
- benefits from a low intermodulation,
- replaces the standard **SMB** and screw-on connectors in all applications requiring:
 - a fast connection
 - a reliable lock-on connection
 - long durability

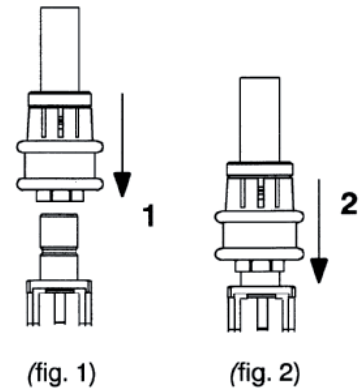

- Possibility to visually control the locking system.

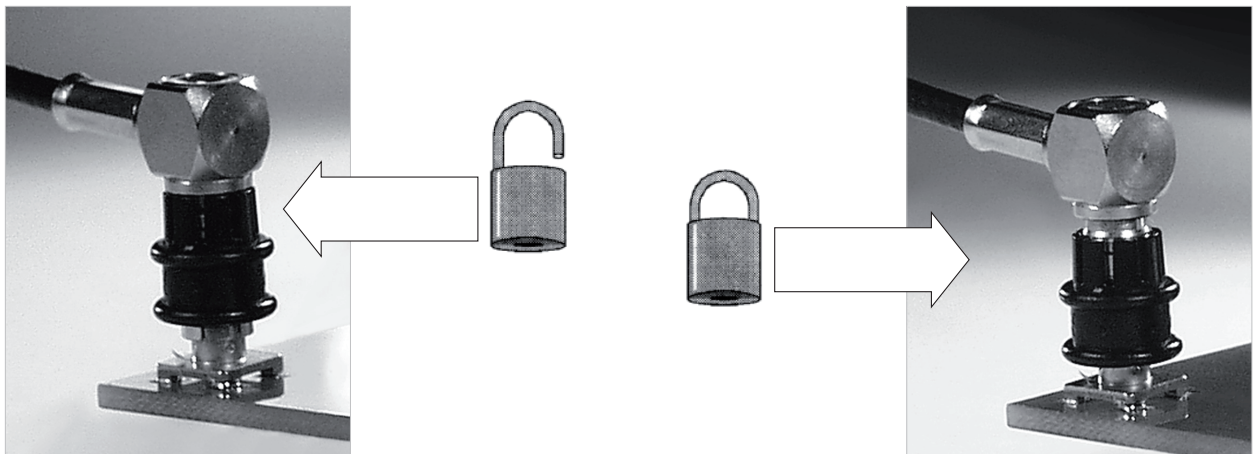

- The connector allows a 360° cable rotation.
- Coupling nut.

The coupling nut is made with POM (halogen free). Its standard color is black.

Interface

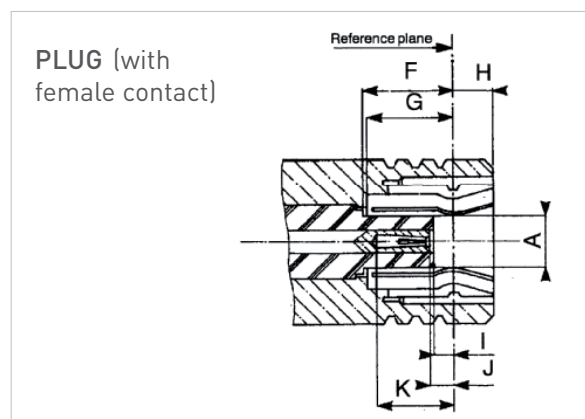

Letter	mm		inch	
	min.	max.	min.	max.
A DIA		2.06		.081
F	3.58		.141	
G	3.58		.141	
H		1.63		.064
I	0.18		.007	
J	0.18	0.94	.007	.037
K	2.97		.117	

Characteristics

Test/characteristics	Values/remarks
----------------------	----------------

ELECTRICAL CHARACTERISTICS

Impedance	50Ω		
Operating frequency	DC to 4 GHz		
Typical V.S.W.R.	2 GHz	4 GHz	
Straight models	.085" ∅ 2.6/50	1.15 1.20	1.20 1.25
Right angle models	.085" ∅ 2.6/50	1.05 1.15	1.15 1.25
RF Insertion loss			
Straight models	.085" ∅ 2.6/50	0.20VF (GHz) 0.25VF (GHz)	
Right angle models	.085" ∅ 2.6/50	0.25VF (GHz) 0.50VF (GHz)	
Testing voltage (V RMS)	.085" ∅ 2.6/50	750 1000	
Working voltage (V RMS)	.085" ∅ 2.6/50	335 335	
Insulation resistance (MΩ)	1000		

MECHANICAL CHARACTERISTICS

Life	500 matings min		
Cable retention force	.085" ∅ 2.6/50 ∅ 5/50/S	220 N 110 N 110 N	
Coupling nut retention force	50 N min		
Vibrations	MIL STD 202 F method 240D, condition B		

ENVIRONMENTAL CHARACTERISTICS

Temperature range	-35°C / + 125°C
-------------------	-----------------

MATERIALS AND PLATING

	Material	Plating
Bodies	Brass	BBR
Center contact	Beryllium copper	Gold
Outer contact	Bronze	
Insulator	PTFE	
Coupling nut	POM (halogen free)	

Standard packaging: 100 pieces (For unit packaging, add "W" after the P/N)

Plugs

STRAIGHT PLUG FULL CRIMP TYPE FOR FLEXIBLE CABLES

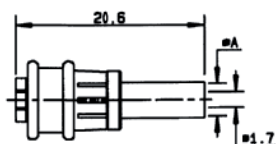

Cable group	Cable group dia	Part number	Dimensions A (mm)	Captive center contact
RG174/RG188/RG316	2.6/50/S	R117 082 807	3.25	yes

RIGHT ANGLE PLUG CRIMP TYPE FOR FLEXIBLE CABLES

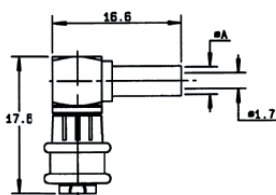

Cable group	Cable group dia	Part number	Dimensions A (mm)	Captive center contact
RG174/RG188/RG316	2.6/50/S	R117 186 807	3.25	yes

Receptacles

- Lower mating/unmating force (from 2.5 N to 6N)
- Receptacles intermateable with SMB connectors
- Gold finish

The SMB limited detent connectors have the same electrical characteristics as standard SMB connectors

BULKHEAD PLUG RECEPTACLE (rear fixing)

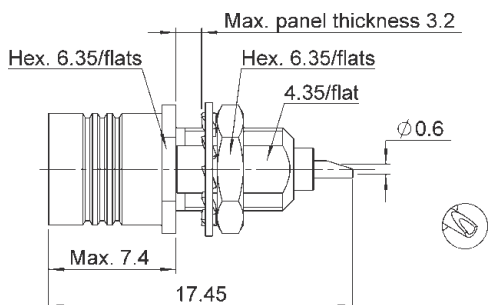

Part number	Panel drilling	Finish
R115 556 000	P08	Gold

Receptacles

STRAIGHT PCB RECEPTACLES (female center contact)

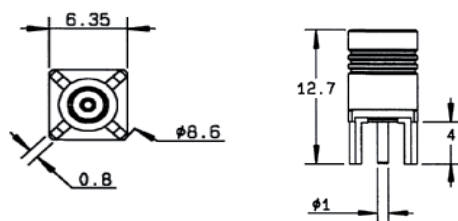

Part number	Captive center contact	Panel drilling	Finish	Packaging
R115 427 000	yes	P05	Gold	Unit

RIGHT ANGLE PCB RECEPTACLE (female center contact)

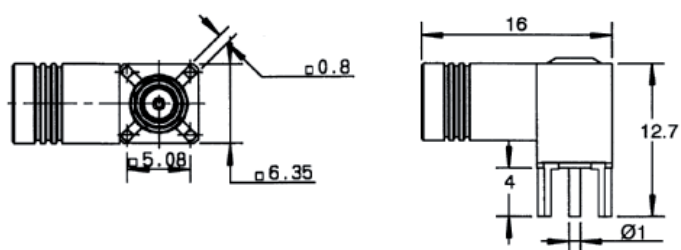
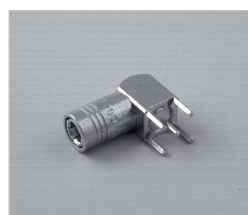

Part number	Captive center contact	Panel drilling	Finish	Packaging
R115 666 000	yes	P04	Gold	Unit

Plugs and receptacles

Slide on connectors (mating/unmating force: 2.2 N to 4.9 N)

The SMB slide-on connectors are completely intermateable with standard SMB and SMB limited detent connectors and in this regard, they can be used for **test applications**. The SMB slide-on connectors have the same electrical characteristics as standard SMB connectors.

PCB RECEPTACLES

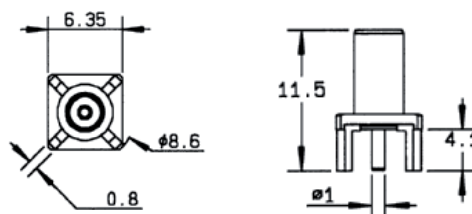
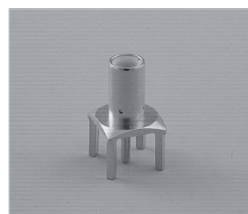

Part number	Captive center contact	Panel drilling	Finish	Packaging	Note
R116 426 000	yes	P03	Gold	Unit	male center contact

SMB limited detent (SMB-A)

Panel drilling

P01

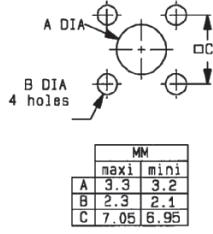

P02

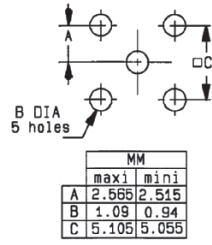

P03

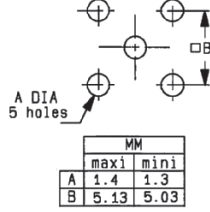

P04

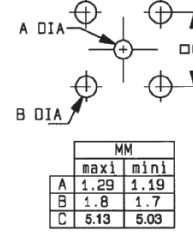

P05

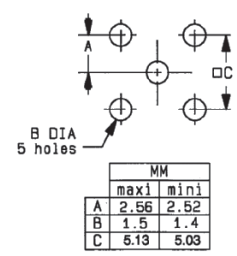

P06

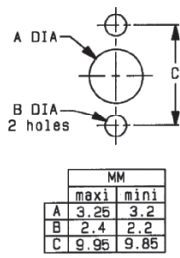

P07

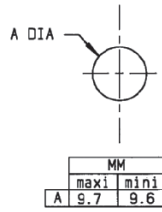

P08

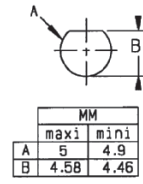

P09

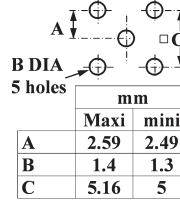

P10

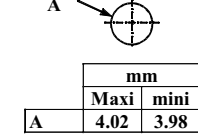

Assembly instructions

M01

Part number
R114 423 000

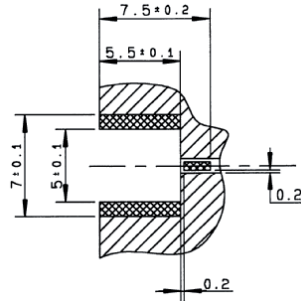

Part number
R114 424 000
R114 424 100
R114 664 000
R114 664 120

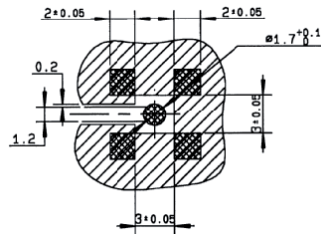

Video shadow:

Part number
R113 423 000

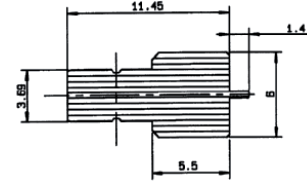

Part number
R114 424 000
R114 424 100

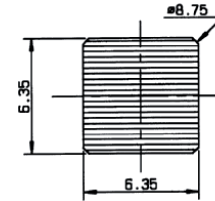

Part number
R114 664 000
R114 664 120

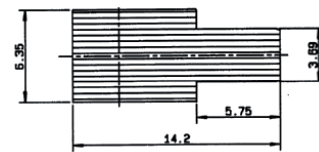

Vaccum nozzle dimensions:

Part number
R114 424 000

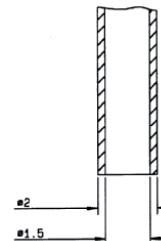

Introduction



50Ω

DC - 10 GHz

GENERAL

- Subminiature coaxial connectors
- Screw-on coupling
- Plugs have female contacts
- Jacks have male contacts
- Low weight
- Reduced outline dimensions

APPLICABLE STANDARDS

- MIL-C-39012

APPLICATIONS

- Civil and military telecommunications
- Aeronautics
- Missiles
- Edge mounting applications

Interface

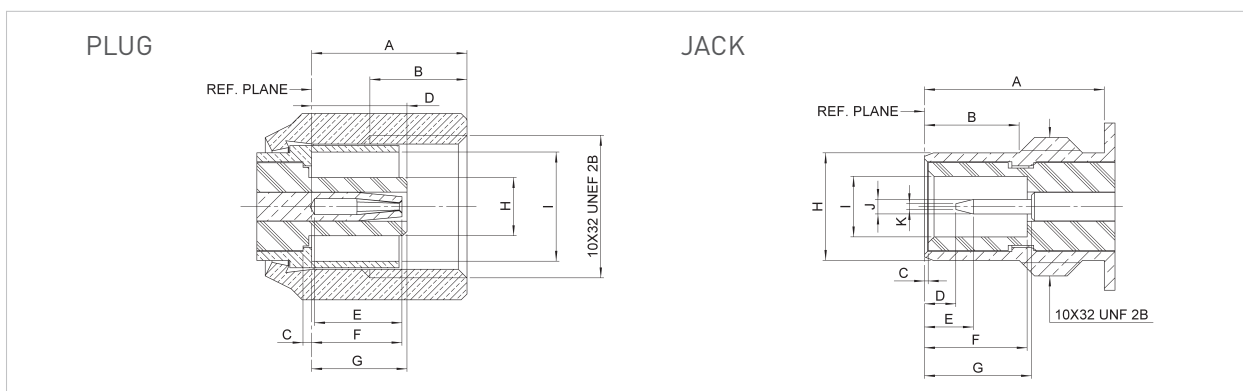

Letter	mm		inch	
	min.	max.	min.	max.
A	5.14	5.55	.202	.219
B	3.20	4.20	.126	.165
C	0.25	0.35	.010	.014
D	2.95	3.00	.116	.118
E	2.80	3.20	.110	.126
F	2.80	3.40	.110	.134
G	3.15	3.40	.124	.134
H	2.00	2.05	.079	.081
I	3.75	3.80	.148	.150

Letter	mm		inch	
	min.	max.	min.	max.
A	6.00	6.20	.236	.244
B	3.15	3.35	.124	.132
C	0.05	0.20	.002	.008
D	0.65	1.50	.026	.059
E	1.30	2.05	.051	.081
F	3.40	3.71	.134	.146
G	3.40	3.95	.134	.156
H	3.65	3.69	.144	.145
I	2.08	2.13	.082	.084
J	0.48	0.52	.019	.020
K	--	0.20	--	.008

Characteristics

Test/characteristics	MIL-C-39012 paragraph	Values/remarks
----------------------	-----------------------	----------------

ELECTRICAL CHARACTERISTICS

Test/characteristics	MIL-C-39012 paragraph	Values/remarks
Impedance		50Ω
Frequency range		DC - 10 GHz
V.S.W.R. (typ.) Straight Right angle	cable 3-14	2/50 1.25 + 0.04 F (GHz) 1.40 + 0.06 F (GHz) 2.6/50 1.20 + 0.04 F (GHz) 1.30 + 0.04 F (GHz)
Insertion loss Straight Right angle	3-27	0.25 dB max. at 4 GHz 0.5 dB max. at 4 GHz
RF leakage	3-26	-60 dB min between 2 and 3 GHz
Insulation resistance	3-11	1000 MΩ min
Contact resistance • center contact (mΩ) • outer contact (mΩ)	3-16	Initial 6 1 After environment 8 1.5
Voltage rating (volts RMS) • at sea level • at 70000 ft (21000 m)	cable	2/50 250 V rms 60 V rms 2.6/50 335 V rms 85 V rms
Dielectric withstanding voltage • at sea level • at 70000 ft (21000 m)	cable	3-17 2/50 750 V rms 185 V rms 2.6/50 1000 V rms 250 V rms
RF high potential withstanding voltage (Frequency 5 MHz) • at sea level	cable	3-23 2/50 500 V rms 2.6/50 700 V rms

MECHANICAL CHARACTERISTICS

Test/characteristics	MIL-C-39012 paragraph	Values/remarks
Durability	3-15	500 matings
Force to engage and disengage	3-5-1	torque: 16 inch-ounces max - 11.3 Ncm
Mating torque		35 to 50 inch-ounces - 25 to 35 Ncm
Coupling nut proof torque		100 inch-ounces - 71 Ncm
Coupling nut retention force	3-25	35 lbs min - 156 N min
Cabling retention force	cable 3-24	2/50 13 lbs - 58 N 2.6/50 25 lbs - 110 N
Contact captivation		Axial force: 4 lbs - 18 N torque: not applicable

ENVIRONMENTAL CHARACTERISTICS

Test/characteristics	MIL-C-39012 paragraph	Values/remarks
Operating temperature range standard models and hermetic models for semi-rigid cables		-65°C / + 165°C -65°C / +105°C
Temperature cycling		MIL-STD-202, method 102, condition C
Thermal shock	3-20	MIL-STD-202, method 107, condition B
High temperature test		MIL-STD-202, method 108
Corrosion (salt spray)	3-13	MIL-STD-202, method 101, condition B, 5%
Vibration	3-18	MIL-STD-202, method 204, condition D, 20g
Shock	3-19	MIL-STD-202, method 213, condition C, 100g
Moisture resistance	3-21	not applicable
Barometric pressure	3-22	MIL-STD-202, method 105, condition C
Hermetic test		Down to 10 ⁻⁶ mm Hg (Torr) Leak rate <1 x 10 ⁻⁶ atm/cm ² /sec

MATERIALS AND PLATING

	Material	Plating
Bodies and male contacts	Brass, half hard per QQ-B-626	Gold to satisfy the corrosion requirements (bodies)
Female contacts and interfaces	Beryllium copper per QQ-C-530	Gold (Center contact)
Ferrules	Brass	
Insulators	PTFE teflon	
Gaskets	Silicone rubber	

All dimensions are given in mm

Plugs and jack

STRAIGHT PLUGS

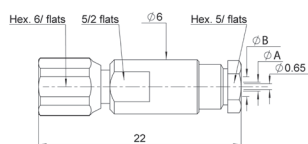

Fig. 1

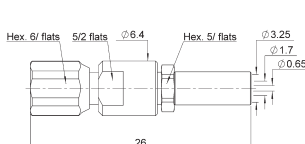

Fig. 2

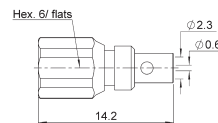

Fig. 3

Cable group	Cable group dia	Part number	Fig	Dimensions mm		Note
				A dia	B dia	
RG178/RG196	2/50/S	R112 003 000	1	1	2.2	Clamp type
RG174/RG316/RG179	2.6/50+75/S	R112 005 000		1.7	3	
			R112 075 000	2		
RG405	.085"	R112 053 000	3			Solder type

RIGHT ANGLE PLUGS

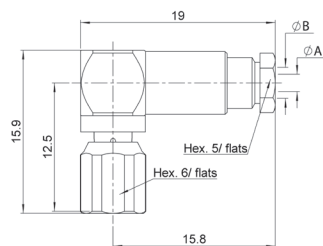

Fig. 1

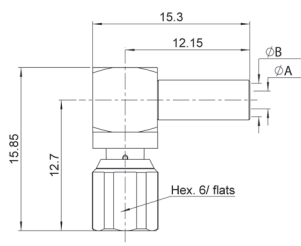
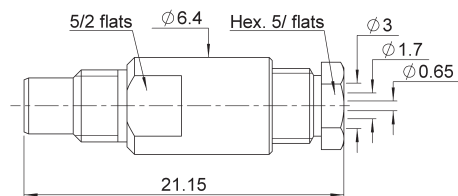

Fig. 2

Cable group	Cable group dia	Part number	Fig	Dimensions mm		Note
				A dia	B dia	
RG174/RG316/RG179	2.6/50+75/S	R112 165 000	1	1.7	3	Crimp type
RG178/RG196	2/50	R112 183 000	2	0.95	2.55	Crimp type
RG174/RG316/RG179	2.6/50+75/S	R112 186 000		1.72	3.25	

STRAIGHT JACK



Cable group	Cable group dia	Part number	Note
RG174/RG316/RG179	2.6/50+75/S	R112 205 000	Clamp type

Jacks and receptacles

BULKHEAD JACKS

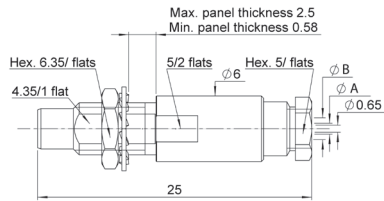

Cable group	Cable group dia	Part number	Dimensions mm		Panel drilling
			A dia	B dia	
RG178/RG196	2/50/S	R112 303 000	1	2	P03
RG174/RG316/RG179	2.6/50+75/S	R112 305 000	1.7	3	

SQUARE FLANGE RECEPTACLES

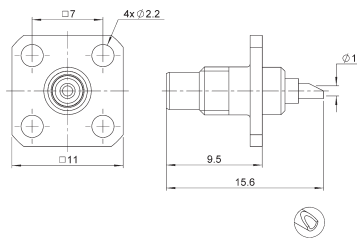

Part number	Panel drilling
R112 403 000	P01

BULKHEAD RECEPTACLES WITH SOLDER POT CONTACT

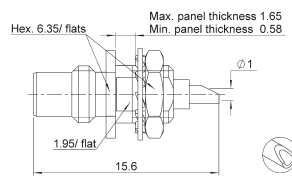

Fig. 1

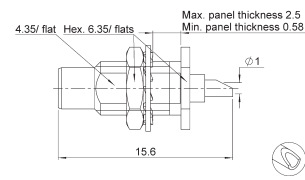

Fig. 2

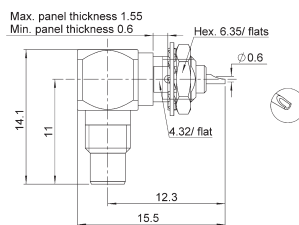

Fig. 3

Part number	Fig	Panel drilling	Note
R112 553 000	1	P03	Rear nut fixing
R112 554 000	2		Front nut fixing
R112 670 000	3		Front mount

Receptacles and adapters

PCB RECEPTACLES

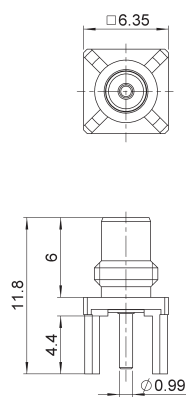

Fig. 1

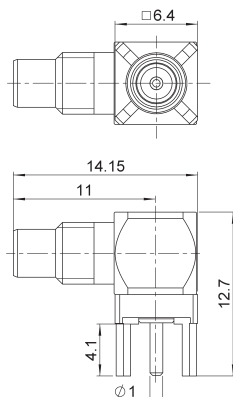

Fig. 2

Part number	Fig	Panel drilling	Note
R112 426 000	1	P02	Solder legs
R112 665 000	2		

IN SERIES ADAPTERS

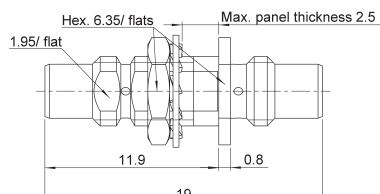

Fig. 1

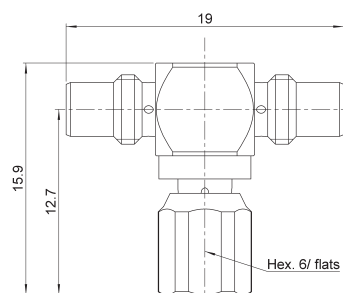
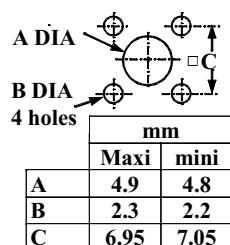

Fig. 2

Part number	Fig	Panel drilling	Note
R112 720 000	1	P03	Male - male
R112 780 000	2		Tee male - male/female

Panel drilling

P01



P02

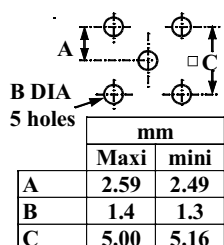

P03

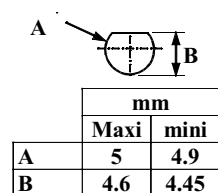

Our Most Important Connection is with You.™

NOTE

